

Greenway Improvement District

12051 Corporate Boulevard Orlando, FL 32817; 407-723-5900

www.greenewayid.org

The following is the proposed agenda for the upcoming Meeting of the Board of Supervisors for the Greenway Improvement District ("District"), scheduled to be held at **3:00 p.m. on Tuesday, November 19, 2019 at 6900 Tavistock Lakes Blvd., Suite 200, Orlando, FL 32827**. A quorum will be confirmed prior to the start of the meeting.

For those unable to attend in person, you may participate by telephone:

Phone: 1-844-621-3695 (new)

Participant Code: 796 580 192# (new)

BOARD OF SUPERVISORS' MEETING AGENDA

Organizational Matters

- Roll Call to Confirm a Quorum
- Public Comment Period
- 1. **Consideration of the Minutes of the October 15, 2019 Board of Supervisors' Meeting**

Business Matters

- 2. **Consideration of Resolution 2020-01, Adopting a Revised Budget for FY 2019 (*provided under separate cover*)**
- 3. **Ratification of Requisition Nos. 665 – 668 & 2018-31 – 2018-36 Approved in October 2019 in an amount totaling \$981,967.04 (*provided under separate cover*)**
- 4. **Ratification of Operation and Maintenance Expenditures Paid in October 2019 in an amount totaling \$84,511.65 (*provided under separate cover*)**
- 5. **Recommendation of Work Authorizations/Proposed Services (*if applicable*)**
- 6. **Review of District's Financial Position and Budget to Actual YTD (*provided under separate cover*)**

Other Business

- A. Staff Reports
 - 1. District Counsel
 - 2. District Manager
 - 3. District Engineer
 - 4. Construction Supervisor

- B. Supervisor Requests

Adjournment



GREENEWAY IMPROVEMENT DISTRICT

**Minutes of the October 15, 2019
Board of Supervisors' Meeting**

**GREENWAY IMPROVEMENT DISTRICT
BOARD OF SUPERVISORS' MEETING MINUTES**

FIRST ORDER OF BUSINESS

The Board of Supervisors' Meeting for the Greenway Improvement District was called to order on Tuesday, October 15, 2019, at 3:00 p.m. at 6900 Tavistock Lakes Blvd., Suite 200, Orlando, FL 32827. Members listed below constituted a quorum.

Richard Levey
Chad Tinetti
Amanda Kost

Chair
Vice-Chair
Assistant Secretary

Also attending:

Jennifer Walden
Tucker Mackie
Jeff Newton
Larry Kaufmann
Scott Thacker

PFM
Hopping Green & Sams
Donald W. McIntosh Associates
Construction Supervisor
Construction Committee

SECOND ORDER OF BUSINESS

Public Comment Period

Dr. Levey noted that there were no members of the public present.

THIRD ORDER OF BUSINESS

**Consideration of Minutes of
the September 17, 2019 Board
of Supervisors' Meeting**

Board Members reviewed the minutes from the September 17, 2019 Board of Supervisors' Meeting.

On Motion by Mr. Tinetti, second by Ms. Kost, with all in favor, the Board of Supervisors for the Greenway Improvement District approved the minutes of the September 17, 2019 Board of Supervisors' Meeting.

FOURTH ORDER OF BUSINESS

**Discussion Regarding
Professional Landscape
Architectural Services**

Ms. Mackie explained that at the last Board meeting staff reviewed two work authorizations for Centerline Drive for landscape architectural services from Dix+Hite. The Board approved those but District staff subsequently had several conversations with the Developer and determined that, since the landscape will be a very important aspect of the roadway design and that consistency is important throughout the Lake Nona Development, Tavistock would like to engage with the landscape architect directly and then the District would acquire that work product at the time that the District is ready to proceed with the actual installation of that product. There was no action required.

FIFTH ORDER OF BUSINESS

Consideration of First Amendment to the Agreement between GID and Cepra Landscape LLC, regarding the Provision of Nemours Parkway Landscape and Irrigation Maintenance Services

Ms. Mackie explained that the District currently has a Landscape Maintenance Agreement with Cepra Landscape LLC. This amendment is for additional services for Phase 6, which recently came out of the two-year maintenance period following completion of the roadway. District staff is requesting to add this portion of the roadway to the existing landscape contract. This was a known quantity at the time of budgeting for this fiscal year. The amount is \$1,985.00 per month will be added to the existing agreement and the area will be included in the bid package when the landscape services are ready to go out to bid next time.

On Motion by Ms. Kost, second by Mr. Tinetti, with all in favor, the Board of Supervisors for the Greenway Improvement District approved the First Amendment to the Agreement between GID and Cepra Landscape LLC, regarding the Provision of Nemours Parkway Landscape and Irrigation Maintenance Services.

SIXTH ORDER OF BUSINESS

Consideration of FY 2019 Audit Engagement Letter

Ms. Walden explained that District Counsel has reviewed the Fiscal Year 2019 Engagement Letter and the comments have been incorporated. The services will not exceed \$4,550.00 unless the scope changes. The District budgeted \$7,000.00 for this line item.

On Motion by Ms. Kost, second by Mr. Tinetti, with all in favor, the Board of Supervisors for the Greenway Improvement District approved the FY 2019 Audit Engagement Letter.

SEVENTH ORDER OF BUSINESS

Agreement for Professional Structural Engineering Services with AVCON, INC.

The District went through an RFQ process to select a structural engineering firm to provide services in the future regarding several bridge or culvert construction features. Included within the agenda package is a general form of engineering services agreement. When the District is ready to proceed with actual design, District staff will present a work authorization to the Board with pricing.

On Motion by Mr. Tinetti, second by Ms. Kost, with all in favor, the Board of Supervisors for the Greenway Improvement District approved the Agreement for Professional Structural Engineering Services with AVCON, INC.

EIGHTH ORDER OF BUSINESS

**Ratification of Requisition
Nos. 663 – 664 & 2018-26 –
2018-30 Approved in
September 2019 in an amount
\$282,960.47**

Board Members reviewed Requisition Nos. 663 – 664 & 2018-26 – 2018-30 Approved in September 2019 in an amount \$282,960.47. Dr. Levey noted that these have already been approved and paid and just need to be ratified by the Board.

On Motion by Ms. Kost, second by Mr. Tinetti, with all in favor, the Board of Supervisors for the Greenway Improvement District ratified Requisition Nos. 663-664 & & 2018-26 – 2018-30 Approved in September 2019 in an amount \$282,960.47.

NINTH ORDER OF BUSINESS

**Ratification of Operation and
Maintenance Expenditures
Paid in September 2019 in the
amount totaling \$126,050.52**

Board Members reviewed the Operation & Maintenance expenditures paid in September 2019 in the amount totaling \$126,050.52. Ms. Walden noted that these have already been approved and paid and just need to be ratified by the Board.

On Motion by Ms. Kost, second by Mr. Tinetti, with all in favor, the Board of Supervisors for the Greenway Improvement District ratified the Operation & Maintenance expenditures paid in September 2019 in the amount totaling \$126,050.52.

TENTH ORDER OF BUSINESS

**Recommendation of Work
Authorizations/Proposed
Services**

Mr. Kaufmann presented a Work Authorization (Minutes Exhibit A) from AVCON for Culvert Structural Design for Centerline Drive Segment A road culverts in the amount of \$10,472.50. Dr. Levey requested a map graphic depicting the location of the work going forward.

On Motion by Mr. Tinetti, second by Ms. Kost, with all in favor, the Board of Supervisors for the Greenway Improvement District approved Work Authorization from AVCON for Culvert Structural Design for Centerline Drive Segment A Road Culverts in the amount of \$10,472.50.

Mr. Kaufmann presented a Work Authorization (Minutes Exhibit B) from Central Florida Locating, Inc. for underground locates for Centerline Drive Road Construction Plans Segment A & B in the amount of \$7,855.00.

On Motion by Tinetti, second by Ms. Kost, with all in favor, the Board of Supervisors for the Greenway Improvement District approved Work Authorization from Central Florida Locating, Inc. for underground locates for Centerline Drive Road Construction Plans Segment A & B in the amount of \$7,855.00.

Mr. Kaufmann presented a Work Authorization (Minutes Exhibit C) from Central Florida Locating, Inc. for underground locates for Centerline Drive Road Construction Plans Segments C & D in the amount of \$15,395.00.

On Motion by Ms. Kost, second by Mr. Tinetti, with all in favor, the Board of Supervisors for the Greenway Improvement District approved Work Authorization from Central Florida Locating, Inc. for underground locates for Centerline Drive Road Construction Plans Segments C & D in the amount of \$15,395.00.

ELEVENTH ORDER OF BUSINESS

Review of District's Financial Position and Budget to Actual YTD

The Board reviewed the District's financial position. Ms. Walden explained that the District has gone over the adopted budget for Fiscal Year 2019 and invoices can still come in through next month. At the next meeting, the Board will be required to approve a revised budget for Fiscal Year 2019. No action was required by the Board today.

The Board reviewed some of the outstanding line items. The landscape maintenance and reclaimed water were the biggest contributors to the overage because the District used some Fiscal Year 2019 funds for hurricane repair under Fiscal Year 2018. Dr. Levey requested a reconciliation for next month. Ms. Lane will be asked to reach out to vendors who have not yet billed the District for FY 2019 services. Questions arose regarding reclaimed water. Mr. Thacker will go back with Ms. Lane and review the bills.

TWELFTH ORDER OF BUSINESS

Staff Reports

District Counsel –

Ms. Mackie noted that Committee weeks have already started earlier this year. So the Board will receive the Capital Conversations newsletter at the end of next month. If anyone wishes not to receive it she can take their name off the list and she will provide reports to the Board at the monthly meetings.

District Manager –

Ms. Walden noted that the next meeting is scheduled for Tuesday, November 19, 2019.

District Engineer –

Mr. Newton circulated the Construction Contract Status Memorandum (Minutes Exhibit D). Jr. Davis completed the erosion repair on October 9, 2019 at Nemours Parkway Phase 6. Repairs to damaged sidewalk, landscape and hardscape are scheduled for the week of October 14, 2019. Punch list walk is anticipated for October 18, 2019.

Nemours Parkway Phase 7 has been fully paved and striping, landscaping and asphalt are complete. The lift station is substantially complete and start up is pending OUC electric installation, which is currently anticipated in early- November. Substantial completion of the project is anticipated on late-November.

Mr. Newton presented Change Order No. 4 in the additive amount of \$49,204.52 for landscape and irrigation revisions for Nemours Parkway Phase 7, as reviewed and approved by Dix+Hite.

A preconstruction meeting with the City regarding the installation of the permanent drainage pipe along Centerline Drive took place on October 8, 2019 and construction by DeWitt Excavation is to commence the week of October 14, 2019. The pipe installation is anticipated to take approximately 3 weeks to complete, followed by close-out inspections and certification.

On Motion by Mr. Tinetti, second by Ms. Kost, with all in favor, the Board of Supervisors for the Greenway Improvement District approved the recommendations of the Construction Contract Status Memorandum dated October 15, 2019 to include Nemours Parkway Phase 7 – Jr. Davis Construction, Inc. Change Order No. 4 for landscape and irrigation revisions, as reviewed and approved by Dix+Hite in the additive amount of \$49,204.52.

Construction Supervisor – Mr. Kaufmann indicated that there are monuments on Nemours Parkway Phase 6 that are scheduled to be installed at the entrance to the project and are still in permitting. They are part of the Nemours Phase 7 Construction Contract but are located at Nemours Phase 6.

THIRTEENTH ORDER OF BUSINESS

Supervisor and Audience Comments & Adjournment

Dr. Levey requested District staff remove the public comment period at the end of the agenda since they have one in the beginning. Ms. Mackie explained that the public comment period at the beginning was established to allow residents to speak on any agenda item before they come to the Board for approval and the comment period at the end was to allow for the public to comment on any items of concern unrelated to the agenda but District staff will remove this comment period going forward.

Mr. Tinetti asked about the ground penetrating radar. Mr. Newton responded that it is money well spent because it helps avoid conflicts encountered during construction, which often lead to redesign and increased construction costs. Ms. Kost asked if it has to be spent every time and if the process could be changed moving forward. Mr. Newton responded it will be challenging and not all as-built surveys are created equally and do not always conform to certain standards. He explained the reason for soft digs and the ground penetrating radar.

There was no further business to discuss. Dr. Levey requested a motion to adjourn.

On Motion by Mr. Tinetti, second by Ms. Kost, with all in favor, the October 15, 2019 Meeting of the Board of Supervisors for the Greenway Improvement District was adjourned.

Secretary/Assistant Secretary

Chair/Vice Chair

GREENWAY IMPROVEMENT DISTRICT

Recommendation for Work Authorization / Proposed Services

Project Name: GID – Centerline Drive Segment A Box Culvert CrossingBrief Description: Culvert Structural Design for Centerline Drive Segment A Road Culverts.

Name of Consultant /Vendor: AVCON, Inc.

Is this work pursuant to an existing Agreement?

☒ Yes ☐ NoIf so, name and date of Agreement:

Is this project included in the District Capital Improvement Plan?

☒ Yes ☐ No

Are the services required contemplated in the Capital Improvement Plan?

☒ Yes ☐ No

Is this a continuation of previously authorized work?

☐ Yes ☒ No

Proposal attached:

☒ Yes ☐ NoForm of Agreement Utilized: Proposal

Amount of Services:

\$ 10,472.50

Recommendation:

☒ Approve ☐ Deny

By:

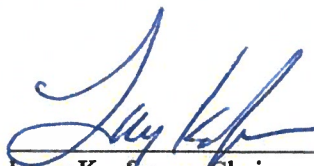
 10/15/19

Larry Kaufmann, Chairman

Greenway Improvement District Construction Committee

c: Jennifer Walden
Tucker Mackie
Jeffrey Newton
Lynne Mullins



AVCON, INC.
ENGINEERS & PLANNERS

5555 E. Michigan Street
Suite 200
Orlando, FL 32822-2779
Phone: (407) 599-1122
Email: avcon@avconinc.com
www.avconinc.com

October 2, 2019

Jeffrey J. Newton, P.E.
District Engineer
Greenway Improvement District
12051 Corporate Boulevard
Orlando, FL 32817

Via email: jjnewton@dwma.com

**Reference: Structural Engineering Scope of Services and Fee Proposal for Centerline
Drive-Segment A Culvert Crossing within the Greenway Improvement District**

Dear Mr. Newton:

AVCON, INC. (AVCON) is pleased to present this scope of services and fee proposal to provide structural engineering design and construction phase services to the Greenway Improvement District. The proposed scope and fee are summarized as follows:

Culvert Structural Design

1. Attend one meeting and coordinate with the roadway/geotechnical design team,
2. Design of Concrete Box Culvert crossings, (Proposed fee is for one (1) crossing. Fee will be increased by a multiple matching the design fee shown for any additional culvert crossings).
3. Prepare 90% and 100% CDs contract documents,
4. Respond to 90% submittal review comments and regulatory review comments received during project permitting, and
5. Post Design Services including:
 - A. Review of shop drawings, product and material submittals, and Contractor testing reports (compaction tests and concrete break tests),
 - B. Response to Contractor RFIs,
 - C. Periodic site visits during construction to observe all pre-concrete placement work to which the Contractor shall receive written confirmation from AVCON prior to placement being made limited to two (2) site visits, and
 - D. Upon completion of the project, AVCON will perform a substantial completion and final walk-through visit and provide a statement, based on periodic construction observations at key times during construction, that the culvert was constructed in substantial conformance with contract documents.

Our proposed fee is outlined on the attached spreadsheet. Thank you for considering AVCON for your consulting needs, we look forward to working with you on this project.

Sincerely,
AVCON, Inc.

RVB
Rick V. Baldocchi, P.E.
Vice President

GREENWAY IMPROVEMENT DISTRICT
Richard [Signature] 10.15.19
CHAIRMAN DATE

Consultant: AVCON, INC.

No./ACTIVITY	Principal		Project Manager		Project Engineer		Designer/CADD		Clerical		TOTAL	
	Man Hours	Hourly Rate	Man Hours	Hourly Rate	Man Hours	Hourly Rate	Man Hours	Hourly Rate	Man Hours	Hourly Rate	Man-hours By Activity	Salary By Activity
Box Culvert Design Phase (1 Crossing Location)												
Meeting Attendance (1)	0.00	225.00	4.00	160.00	0.00	120.00	0.00	110.00	0.00	60.00	4	640.00
Roadway/Geotechnical Design Coordination	0.00	225.00	1.00	160.00	2.00	120.00	0.00	110.00	0.00	60.00	3	400.00
90% CDs Submittal	0.00	225.00	1.00	160.00	8.00	120.00	16.00	110.00	1.00	60.00	26	2,940.00
90% CDs Review Comments	1.00	225.00	1.00	160.00	2.00	120.00	0.00	110.00	1.00	60.00	5	685.00
100% CDs Submittal	0.00	225.00	1.00	160.00	2.00	120.00	8.00	110.00	1.00	60.00	12	1,340.00
QA/QC	1.00	225.00	1.00	160.00	1.00	120.00	1.00	110.00	0.00	60.00	4	615.00
Sub-Total											64	\$6,820.00
Box Culvert Post Design Phase												
Response to Contractor RFIs	0.00	225.00	2.00	160.00	0.00	120.00	0.00	110.00	0.00	60.00	2	320.00
Review Shop Drawings	0.00	225.00	2.00	160.00	4.00	120.00	0.00	110.00	0.00	60.00	6	800.00
Site Visits (2)	0.00	225.00	8.00	160.00	8.00	120.00	0.00	110.00	0.00	60.00	16	2,240.00
Substantial Completion and Closeout Letter	0.50	225.00	2.00	160.00	0.00	120.00	0.00	110.00	1.00	60.00	4	492.50
Sub-Total											28	\$3,852.50
Total Man-hours												
Total Salary [(MHxHR)]	3		23		27		25		4		82	\$10,472.50

GREENWAY IMPROVEMENT DISTRICT

Recommendation for Work Authorization / Proposed Services

Project Name: GID – Centerline Drive Segment A & BBrief Description: Underground locates for Centerline Drive Road Construction Plans.

Name of Consultant /Vendor: Central Florida Locating, Inc.Is this work pursuant to an existing Agreement? ☒ Yes ☐ No

If so, name and date of Agreement: _____

Is this project included in the District Capital Improvement Plan? ☒ Yes ☐ NoAre the services required contemplated in the Capital Improvement Plan? ☒ Yes ☐ NoIs this a continuation of previously authorized work? ☐ Yes ☒ NoProposal attached: ☒ Yes ☐ NoForm of Agreement Utilized: ProposalAmount of Services: \$ 7,855.00Recommendation: ☒ Approve ☐ DenyBy:  10/15/19Larry Kaufmann, Chairman
Greenway Improvement District Construction Committeec: Jennifer Walden
Tucker Mackie
Jeffrey Newton
Lynne Mullins



PO Box 1468
Bushnell, FL 33513
833-229-2227
cfl-inc.com

Central Florida Locating, Inc.
d/b/a CFL Geological Solutions

Date: 9-20-19

Client: Greenway Improvement District, 12051 Corporate Blvd, Orlando, FL 32817

Attn: Mr. Richard Levey, Chairman, Board of Supervisors

E-Mail: Scott Grossman, PSM, Senior Vice President, Donald W. McIntosh Associates, Inc. <sgrossman@dwma.com>

Project: Centerline Drive Segments A & B – Nemours Pkwy & Tavistock Lk Blvd, Orlando, FL

CFL 19259 REV 1

CFL is pleased to provide a revised proposal to Greenway Improvement District based upon scope of services requested by Scott Grossman of D.W. McIntosh Associates (DWMA), may be subject to change should the requirements change, is valid for thirty (30) days from date of proposal, and is Non-Transferrable.

SCOPE OF SERVICES - See Page 2 for Information/Limitations

Geophysical Horizontal Utility Locating: 2D Ground Penetrating Radar (GPR) and Electromagnetic (EM)

- CFL will utilize 2D GPR and EM technologies to horizontally locate underground utilities within the 3 red outlined areas (Segments A & B) as shown on the attached image. The exact locate areas will need to be designated at time of work by DWMA.
- CFL will use paint and flags to mark located utilities.
- CFL will provide a technician's field drawing of located utilities.
- CFL's scope of services does not include the locating of abandoned utilities that are no longer locatable, vacant conduits, gravity sewer, storm lines, small irrigation lines, and low voltage lines.
- Client is responsible for ensuring that all electrical and lighting systems are energized and that all lights with outdoor light sensor systems are in use at time of locate work.

Notes:

- If available, CFL requests that client provide as-builts, engineering prints, etc. of existing utilities.
- GPR Scans & EM Locating can only be performed in accessible areas that are clear of obstacles such as construction materials, pipes, vehicles, machinery, dirt/materials mounds, landscaping, trees, uneven terrain, water, etc.
- If needed, CFL can provide a quote for additional detection technologies such as 3D GPR, 3D GPR Array, Magnetometer, and Direct Pushes that typically provide additional/more comprehensive data.

Vertical Excavations – Dirt Soft Digs See Item E for Soft Dig Information/Limitations.

CFL will vertically expose up to 8 horizontally located utilities within sites to be designated by DWMA.

WEEKDAY DAYTIME COST

Geophysical Horizontal Locating: _____ \$ 5,655.00

Vertical Excavations – Up to 8 Dirt Soft Digs – (5 Hole Minimum Charge Applicable) _____ \$ 2,200.00*

*Dirt Soft Digs over 8 will be invoiced at \$275.00 per hole.

PAYMENT

- A Lump Sum invoice will be submitted via e-mail to client upon completion of locate work.
- Lump Sum amount is due in full with no job retainage.
- Payments not received within 30 days of date of invoice may result in legal actions.

SCHEDULE

A work start date will be provided upon receiving an Authorization to Proceed.

Regards,

Sandra Rickerson

Sandra Rickerson, President
Central Florida Locating, Inc.

AUTHORIZATION TO PROCEED (ATP) – Executed CFL Proposal

ATP - Client legally authorizes CFL to proceed and acknowledges that scope of services, compensation, payment terms, and terms and conditions in this proposal are accepted.

Client: Greenway Improvement District

Date: 10.15.19

By: _____

Authorized Agent's Signature

Printed Name: RICHARD LEVEY

Printed Name of Authorized Agent

Job Number/Name (If Applicable): _____

E-MAIL Address for Invoice: _____

E-MAIL EXECUTED DOCUMENT TO: Contracts@cfl-inc.com

Innovative and Reliable Solutions



Terms and Conditions

Central Florida Locating, Inc.
dba CFL Geological Solutions

Page 2

(A) LIMITS OF GPR AND ELECTROMAGNETIC SERVICES: If Services are Provided

CFL will make every effort to horizontally detect the underground utilities, objects or voids described in the Scope of Work or as requested at the time of work within the designated work area(s). However, CFL cannot mark utilities/objects/voids that are undetectable. Therefore, CFL **cannot guarantee** that all subsurface utilities/objects/voids will be accounted for. Locate limitations that CFL will not be held liable for include but are not limited to:

- **GROUND PENETRATING RADAR (GPR):**
 - GPR investigations are highly site specific and can be limited by attenuation of GPR signals by subsurface materials.
 - GPR investigations are limited by uneven terrain conditions, bushes, trees, debris, etc.
 - All vertically stacked utilities/objects may not be detected since GPR signals are reflected by the top most utility/object.
 - Some utilities/objects may not return a reflected signal to the GPR receiver.
 - GPR scans cannot be made immediately next to buildings/objects due to equipment restrictions.
 - Pipes with little or no liquid content at time of locate work may not be detected with GPR.
- **ELECTROMAGNETIC LOCATING :**
 - The number of access points within designated locate area(s) may be limited or non-existent.
 - Utility or property owner may restrict or deny the use of utility access points.
 - Utility may not adequately carry the imposed current from the electromagnetic locate equipment.
 - Fiber & other non-metallic lines with no or non-working tracer wire are untoneable with electromagnetic locate equipment.

(B) DESIGN ENGINEER and CONTRACTORS

Due to locate limitations, the client's/owner's **Design Engineer** is expected to gather and identify existing facility information from various prints and underground facility owners/operators to confirm that no other subsurface utilities/objects are present in the project area, and **Contractors** are responsible to abide by Florida Statutes 556.106 - Sunshine 811.

(C) FIELD DRAWINGS/PRINTS/REPORTS

CFL is not liable for any print, survey, field drawing or report that identifies or fails to identify CFL detected utilities or objects. CFL field drawings represent the requested scope of services within designated area(s) as of date of work; may not reflect a comprehensive utility survey of all subsurface utilities/objects; are not technical drawings created by a professional such as surveyor, engineer, or draftsman; are not drawn to scale and only depict an approximate location of referenced utilities/objects; are not created based on any type of drawing standards; and are for informational purposes only.

(D) MACHINE DEPTHS: If Service is Provided

Machine depths are approximate readings, **are not guaranteed depths**, are provided for informational purposes only, and should not be relied upon for any type of subsurface work. CFL will not accept any responsibility for actions taken based on provided machine depths.

(E) VERTICAL EXCAVATION (DIRT SOFT DIG): Information/Limitations: If Service is Provided

Soft Digs are made within grassed or otherwise unpaved surface conditions to a maximum depth of approximately 8 feet to determine the depth of the utility/object. If requested, CFL also will provide the size and material type.

- Soft Dig vertical depth measurements are made from the top of each exposed utility/object to the ground surface.
- The vertical depth range and visual inspection ability is dependent on events such as ground water level.
- Client must obtain/provide CFL with any required soft dig permits before soft dig work is performed. Client will be responsible for any permitting soft dig fines assessed by governing agency.

(F) CORE BORE WITH VERTICAL EXCAVATION (DIRT SOFT DIG): Information/Limitations: If Service is Provided

A Core Bore is made in asphalt or concrete to vertically expose a utility/object to determine the depth of the utility/object from the top of the utility/object to the pavement surface.

- Vertical Excavation limits apply (See Item E).
- Test hole will be backfilled with like materials compacted in 6" lifts or with a flowable fill mixture.
- The current asphalt thickness will be replaced with double asphalt thickness.
- **Asphalt/Concrete Core Bore Permits are to be furnished to CFL by the client prior to work being scheduled.** Client is responsible for cost of all permits, MOT, Traffic Control, and any permitting fines assessed by governing agency.

(G) DIRECT PUSH SOIL SAMPLING: Information/Limitations: If Service is Provided

Direct Push Soil Sampling limitations that CFL will not be held liable for include but are not limited to:

- Direct push rods may not penetrate to desired depth due to subsurface sediment and/or material hardness.
- Direct push rods may not penetrate through consolidated sediment, rock and/or debris.

(H) CERTIFICATE OF INS (COI): New/Revised COI Requests

- Client COI requirements must be provided to CFL prior to the Authorization to Proceed being issued.
- CFL will invoice client for all costs associated with client COI requirements that incur billable charges to CFL.

Innovative and Reliable Solutions

OCPA Web Map



Major Road

Public Road

Graded Road



**CFL Utility Locate Site:
Nemours Pkwy and Tavistock Lk Blvd
Orlando, FL
Centerline Drive Segments A & B Locations**

Courtesy Rick Singh, CFA, Orange County Property Appraiser



Segment A
CFL will locate underground utilities within the red outlined area.

Segment B
CFL will locate underground utilities within the red outlined area.

Segment B
CFL will locate underground utilities within the red outlined area.

Created: 9/14/2019

This map is for reference only and is not a survey.

EXHIBIT A
WORK SCOPE AUTHORIZATION/AGREEMENT LETTER FORM

9-20-19

Greenway Improvement District
12051 Corporate Blvd
Orlando, Florida 32817

Subject: Central Florida Locating, Inc. – Proposal 19259 REV 1 – Centerline Drive Segments A & B

Consultant submits this work authorization to provide Services Greenway Improvement District. We will provide these services pursuant to our current Agreement dated September 20, 2019 ("Agreement") as follows:

I. Scope of Work

_____	A. (GPR of Centerline Dr Segments A & B)	\$5,655.00
[Code]		
_____	B. (Vertical Excavations -Dirt)	\$2,200.00
[Code]		
_____	C. (insert work description)	\$
TOTAL	-----	\$7,855.00

II. Compensation

Consultant will be compensated for this work at the quoted lump sum amount or at the hourly rates and direct costs established pursuant to the Agreement.

This Work Scope Authorization, together with the Agreement, represents the entire understanding between Greenway Improvement District and Consultant with regard to the referenced Work Authorization. If you wish to accept this Work Authorization, please sign both copies where indicated and return one complete copy to our office (executed electronic scanned copies are acceptable). Upon receipt, we will promptly schedule our services.

Sincerely,

By: Sandra Richerson
Title: President

APPROVED AND ACCEPTED

Richard J. [Signature]
[Signature]
RICHARD J. [Name and Title] CHAIRMAN

10.15.19
[Date]

[Company]

[Project No.]

[Work Authorization No.]

GREENWAY IMPROVEMENT DISTRICT

Recommendation for Work Authorization / Proposed Services

Project Name: GID – Centerline Drive Segment C & DBrief Description: Underground locates for Centerline Drive Road Construction Plans.

Name of Consultant /Vendor: Central Florida Locating, Inc.

Is this work pursuant to an existing Agreement?

☒ Yes ☐ No

If so, name and date of Agreement: _____

Is this project included in the District Capital Improvement Plan?

☒ Yes ☐ No

Are the services required contemplated in the Capital Improvement Plan?

☒ Yes ☐ No

Is this a continuation of previously authorized work?

☐ Yes ☒ No

Proposal attached:

☒ Yes ☐ NoForm of Agreement Utilized: Proposal

Amount of Services:

\$ 15,395.00

Recommendation:

☒ Approve ☐ Deny

By:

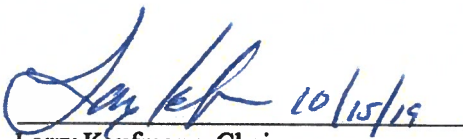
 10/15/19

Larry Kaufmann, Chairman

Greenway Improvement District Construction Committee

c: Jennifer Walden
Tucker Mackie
Jeffrey Newton
Lynne Mullins



PO Box 1468
Bushnell, FL 33513
833-229-2227
cfl-inc.com

Central Florida Locating, Inc.
CFL Geological Solutions

Date: 9-20-19
Client: Greenway Improvement District, 12051 Corporate Blvd, Orlando, FL 32817
Attn: Mr. Richard Levey, Chairman, Board of Supervisors
E-Mail: Scott Grossman, PSM, Senior Vice President, Donald W. McIntosh Associates, Inc. <sgrossman@dwma.com>
Project: **Centerline Drive Segment C** – Centerline Cr. & Laureate Blvd, Orlando, FL;
Centerline Drive Segment D – Centerline Dr & Kellogg Ave, Orlando, FL

CFL 19258 REV 1

CFL is pleased to provide a revised proposal to Greenway Improvement District based upon scope of services requested by Scott Grossman of D.W. McIntosh Associates (DWMA), may be subject to change should the requirements change, is valid for thirty (30) days from date of proposal, and is Non-Transferrable.

SCOPE OF SERVICES - See Page 2 for Information/Limitations

Geophysical Horizontal Utility Locating: 2D Ground Penetrating Radar (GPR) and Electromagnetic (EM)

- CFL will utilize 2D GPR and EM technologies to horizontally locate underground utilities within the 3 red outlined areas (Segments C & D) as shown on the attached images. The exact locate areas will need to be designated at time of work by DWMA.
 - *Segment D Note: Information provided to CFL does not show utilities running west of the intersection within the red outlined area. CFL's proposal is based on this information. If utilities are found during horizontal locating, CFL will submit a Change Order for additional locate time.*
- CFL will use paint and flags to mark located utilities and will provide a technician's field drawing of located utilities.
- CFL's scope of services does not include the locating of abandoned utilities that are no longer locatable, vacant conduits, gravity sewer, storm lines, small irrigation lines, and low voltage lines.
- *Client is responsible for ensuring that all electrical and lighting systems are energized and that all lights with outdoor light sensor systems are in use at time of locate work.*

Notes:

- *If available, CFL requests that client provide as-builts, engineering prints, etc. of existing utilities.*
- *GPR Scans & EM Locating can only be performed in accessible areas that are clear of obstacles such as construction materials, pipes, vehicles, machinery, dirt/materials mounds, landscaping, trees, uneven terrain, water, etc.*
- *If needed, CFL can provide a quote for additional detection technologies such as 3D GPR, 3D GPR Array, Magnetometer, and Direct Pushes that typically provide additional/more comprehensive data.*

Vertical Excavations – Dirt Soft Digs See Item E for Soft Dig Information/Limitations.

CFL will vertically expose up to 8 horizontally located utilities within sites to be designated by DWMA.

WEEKDAY DAYTIME COST

Geophysical Horizontal Locating: ----- \$13,195.00

Vertical Excavations – Up to 8 Dirt Soft Digs – (5 Hole Minimum Charge Applicable) ----- \$ 2,200.00*

*Dirt Soft Digs over 8 will be invoiced at \$275.00 per hole.

PAYMENT

- A Lump Sum Invoice will be submitted via e-mail to client upon completion of locate work.
- Lump Sum amount is due in full with no job retainage.
- Payments not received within 30 days of date of invoice may result in legal actions.

SCHEDULE

A work start date will be provided upon receiving an Authorization to Proceed.

Regards,

Sandra Rickerson

Sandra Rickerson, President
Central Florida Locating, Inc.

AUTHORIZATION TO PROCEED (ATP) – Executed CFL Proposal

ATP - Client legally authorizes CFL to proceed and acknowledges that scope of services, compensation, payment terms, and terms and conditions in this proposal are accepted.

Client: **Greenway Improvement District**

Date: 10-15-19

By: *Richard Levey*
Authorized Agent's Signature

Printed Name: Richard Levey
Printed Name of Authorized Agent

Job Number/Name (If Applicable): _____

E-MAIL Address for Invoice: _____

E-MAIL EXECUTED DOCUMENT TO: Contracts@cfl-inc.com

Innovative and Reliable Solutions



Central Florida Locating, Inc.
CFL Geological Solutions

Terms and Conditions

Page 2

(A) LIMITS OF GPR AND ELECTROMAGNETIC SERVICES: If Services are Provided

CFL will make every effort to horizontally detect the underground utilities, objects or voids described in the Scope of Work or as requested at the time of work within the designated work area(s). However, CFL cannot mark utilities/objects/voids that are undetectable. Therefore, CFL **cannot guarantee** that all subsurface utilities/objects/voids will be accounted for. Locate limitations that CFL will not be held liable for include but are not limited to:

- **GROUND PENETRATING RADAR (GPR):**
 - GPR investigations are highly site specific and can be limited by attenuation of GPR signals by subsurface materials.
 - GPR investigations are limited by uneven terrain conditions, bushes, trees, debris, etc.
 - All vertically stacked utilities/objects may not be detected since GPR signals are reflected by the top most utility/object.
 - Some utilities/objects may not return a reflected signal to the GPR receiver.
 - GPR scans cannot be made immediately next to buildings/objects due to equipment restrictions.
 - Pipes with little or no liquid content at time of locate work may not be detected with GPR.
- **ELECTROMAGNETIC LOCATING :**
 - The number of access points within designated locate area(s) may be limited or non-existent.
 - Utility or property owner may restrict or deny the use of utility access points.
 - Utility may not adequately carry the imposed current from the electromagnetic locate equipment.
 - Fiber & other non-metallic lines with no or non-working tracer wire are untoneable with electromagnetic locate equipment.

(B) DESIGN ENGINEER and CONTRACTORS

Due to locate limitations, the client's/owner's **Design Engineer** is expected to gather and identify existing facility information from various prints and underground facility owners/operators to confirm that no other subsurface utilities/objects are present in the project area, and **Contractors** are responsible to abide by Florida Statutes 556.106 - Sunshine 811.

(C) FIELD DRAWINGS/PRINTS/REPORTS

CFL is not liable for any print, survey, field drawing or report that identifies or fails to identify CFL detected utilities or objects. CFL field drawings represent the requested scope of services within designated area(s) as of date of work; may not reflect a comprehensive utility survey of all subsurface utilities/objects; are not technical drawings created by a professional such as surveyor, engineer, or draftsman; are not drawn to scale and only depict an approximate location of referenced utilities/objects; are not created based on any type of drawing standards; and are for informational purposes only.

(D) MACHINE DEPTHS: If Service Is Provided

Machine depths are approximate readings, **are not guaranteed depths**, are provided for informational purposes only, and should not be relied upon for any type of subsurface work. CFL will not accept any responsibility for actions taken based on provided machine depths.

(E) VERTICAL EXCAVATION (DIRT SOFT DIG): Information/Limitations: If Service Is Provided

Soft Digs are made within grassed or otherwise unpaved surface conditions to a maximum depth of approximately 8 feet to determine the depth of the utility/object. If requested, CFL also will provide the size and material type.

- Soft Dig vertical depth measurements are made from the top of each exposed utility/object to the ground surface.
- The vertical depth range and visual inspection ability is dependent on events such as ground water level.
- Client must obtain/provide CFL with any required soft dig permits before soft dig work is performed. Client will be responsible for any permitting soft dig fines assessed by governing agency.

(F) CORE BORE WITH VERTICAL EXCAVATION (DIRT SOFT DIG): Information/Limitations: If Service Is Provided

A Core Bore is made in asphalt or concrete to vertically expose a utility/object to determine the depth of the utility/object from the top of the utility/object to the pavement surface.

- Vertical Excavation limits apply (See Item E).
- Test hole will be backfilled with like materials compacted in 6" lifts or with a flowable fill mixture.
- The current asphalt thickness will be replaced with double asphalt thickness.
- **Asphalt/Concrete Core Bore Permits are to be furnished to CFL by the client prior to work being scheduled.** Client is responsible for cost of all permits, MOT, Traffic Control, and any permitting fines assessed by governing agency.

(G) DIRECT PUSH SOIL SAMPLING: Information/Limitations: If Service Is Provided

Direct Push Soil Sampling limitations that CFL will not be held liable for include but are not limited to:









- Direct push rods may not penetrate to desired depth due to subsurface sediment and/or material hardness.
- Direct push rods may not penetrate through consolidated sediment, rock and/or debris.

(H) CERTIFICATE OF INS (COI): New/Revised COI Requests

- Client COI requirements must be provided to CFL prior to the Authorization to Proceed being issued.
- CFL will invoice client for all costs associated with client COI requirements that incur billable charges to CFL.

Innovative and Reliable Solutions

OCPA Web Map

- | | | |
|--|---|---|
|  Florida Turnpike |  Major Roads |  Public Roads |
|  Interstate 4 |  Gated Roads |  Railroad |
|  Toll Road |  Road Under Construction |  Proposed Road |

**CFL Utility Locate Site:
Centerline Cr. and Laureate Blvd
Orlando, FL
Centerline Drive Segment C Location**

Courtesy Rick Singh, CFA, Orange County Property Appraiser

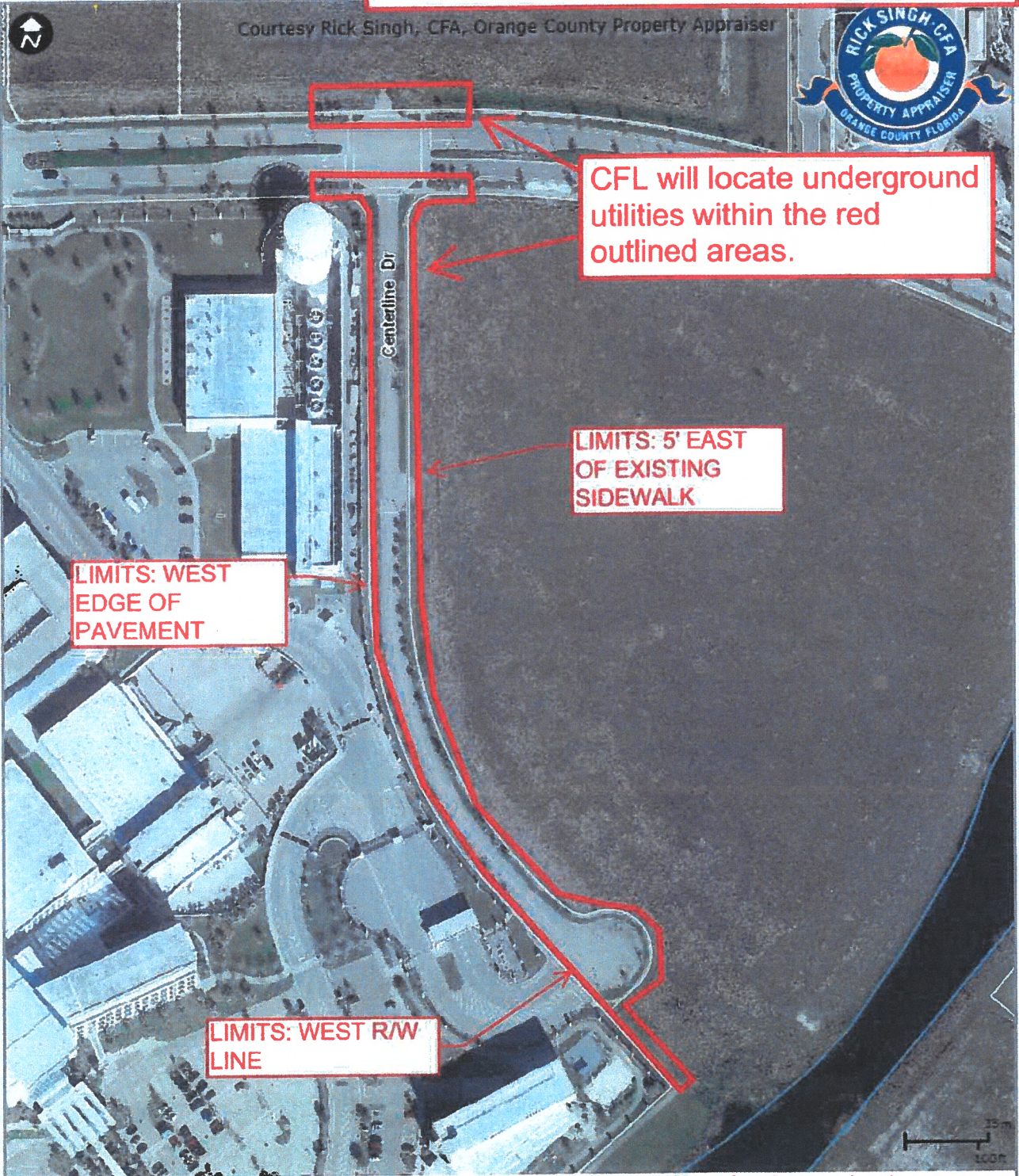

Created: 9/14/2019

This map is for reference only and is not a survey.

OCPA Web Map

Florida
turnpike

Interstate 4

Toll Road

Major Roads

Public Roads

Graded Roads

Road Under
Construction

**CFL Utility Locate Site:
Centerline Dr and Kellogg Ave
Orlando, FL
Centerline Drive Segment D Location**



Courtesy Rick Singh, CFA, Orange County Property Appraiser



**CFL will locate underground utilities
within the red outlined area.**

**Note: Information provided to CFL does not
show utilities running west of the intersection
within the red outlined area. CFL's proposal is
based on this information. If utilities are found
during horizontal locating, CFL will submit a
Change Order for additional locate time.*

Created: 9/14/2019

This map is for reference only and is not a survey.

EXHIBIT A
WORK SCOPE AUTHORIZATION/AGREEMENT LETTER FORM

9-20-19

Greenway Improvement District
12051 Corporate Blvd
Orlando, Florida 32817

Subject: Central Florida Locating, Inc. – Proposal 19258 REV 1 – Centerline Drive Segments C & D

Consultant submits this work authorization to provide Services Greenway Improvement District. We will provide these services pursuant to our current Agreement dated September 20, 2019 ("Agreement") as follows:

I. Scope of Work

_____	A. (GPR of Centerline Dr Segments C & D)	\$13,195.00
[Code]		
_____	B. (Vertical Excavations -Dirt)	\$2,200.00
[Code]		
_____	C. (insert work description)	\$
TOTAL		\$15,395.00

II. Compensation

Consultant will be compensated for this work at the quoted lump sum amount or at the hourly rates and direct costs established pursuant to the Agreement.

This Work Scope Authorization, together with the Agreement, represents the entire understanding between Greenway Improvement District and Consultant with regard to the referenced Work Authorization. If you wish to accept this Work Authorization, please sign both copies where indicated and return one complete copy to our office (executed electronic scanned copies are acceptable). Upon receipt, we will promptly schedule our services.

Sincerely,

By: Sandra Rickman
Title: President

APPROVED AND ACCEPTED

Richard Leighton
[Signature]
[Name and Title]

[Project No.]

10.15.19
[Date]

[Company]

[Work Authorization No.]



MEMORANDUM

**DONALD W. MCINTOSH
ASSOCIATES, INC.**

DATE: October 15, 2019

TO: Greenway Improvement District
Board of Supervisors

FROM: Donald W. McIntosh Associates, Inc.
District Engineer

RE: Construction Contract Status

Dear Board Members,

Please accept this correspondence as a current summary of our construction contract status. Listed below by project is a brief summary of recent contract activity. Copies of the latest Change Order logs are attached.

CIVIL ENGINEERS

LAND PLANNERS

SURVEYORS

Nemours Parkway Phase 6 – Jr. Davis Construction, Inc. / BrightView

Construction Status: Jr. Davis Construction completed the erosion repair on 10/9/19. Repairs to damaged sidewalk, landscape and hardscape are scheduled for the week of 10/14/19. Punch list walk is anticipated 10/18/19.

Change Order (C.O.) Status: None at this time.

Recommended Motion: None at this time.

Nemours Parkway Phase 7 – Jr. Davis Construction, Inc.

Construction Status: The roadway has been fully paved and striping, landscaping and asphalt trail are complete. The lift station is substantially complete and start up is pending OUC electric installation, which is currently anticipated in early-November. Substantial completion of the project is anticipated in late-November.

Change Order (C.O.) Status: Change Order No. 4 in the additive amount of \$49,204.52 for landscape and irrigation revisions, as reviewed and approved by Dix+Hite.

Recommended Motion: Approve Change Order No. 4 in the additive amount of \$49,204.52.

2200 Park Ave. North

Winter Park, FL

32789-2355

Fax 407-644-8318

407-644-4068

F:\Proj2003\23216\ENGadmin\C\ec1315.docx

<http://www.dwma.com>



Memorandum

Re: Greenway Improvement District

Construction Contract Status

October 15, 2019

Page 2

Lake Nona Kellogg Avenue Extension – DeWitt Excavation

Construction Status: A preconstruction meeting with the City took place 10/8/19 and construction of the permanent drainage pipe is to commence the week of 10/14/19. The pipe installation is anticipated to take approximately 3 weeks to complete, followed by close-out inspections and certification.

Change Order (C.O.) Status: None at this time.

Recommended Motion: None at this time.

Should there be any questions, please do not hesitate to call.

Thank you.

End of memorandum.

c: Larry Kaufmann
Scott Thacker
Troy Davidson
Dan Young
Tarek Fahmy

**LAKE NONA SOUTH
Greenway Improvement District
Nemours Parkway Phase 6
Change Order Log
Jr. Davis**

C.O. #	Date	Description of Revision	Additional Days	Amount	Status	New Contract Amount Original Contract Date 8/17/17	To Board	Approval Date	Notes
						\$2,070,587.60			
<u>1</u>	7/10/2018	8" Directional Bore	0	\$ 10,874.88	Approved	\$ 2,081,462.48	7/17/2018	7/17/2018	
<u>2</u>	6/20/2018	Culvert Rail Installation	0	\$ 13,464.00	Approved	\$ 2,094,926.48	7/17/2018	7/17/2018	
<u>3</u>	7/16/2018	OCPS sidewalk revision	30	\$ 42,220.54	Approved	\$ 2,137,147.02	7/17/2018	7/17/2018	
<u>4</u>	5/20/2019	Erosion repair and expanded protection at the north and south ends of the quad 36" culverts	0	\$ 77,713.83	Approved	\$ 2,214,860.85	5/21/2019	5/21/2019	

**LAKE NONA SOUTH
Greenway Improvement District
Nemours Parkway Phase 7
Change Order Log
Jr. Davis**

C.O. #	Date	Description of Revision	Additional Days	Amount	Status	New Contract Amount Original Contract Date	To Board	Approval Date	Notes
						\$6,312,276.78			
<u>1</u>	2/8/2019	Contract adjustment for revision to include scope of work for addendums/plans issued after bid date.		\$ 161,445.97	Approved	\$ 6,473,722.75	2/19/2019	2/19/2019	
<u>2</u>	5/20/2019	Add sanitary and reclaim service laterals intended to serve the Nemours Childrens's Hospital.		\$ 12,879.00	Approved	\$ 6,486,601.75	5/21/2019	5/21/2019	
<u>3</u>	9/12/2019	Contract Calendar Extension - Add 60 Days	60	\$ -	Approved	\$ 6,486,601.75	9/17/2019	9/17/2019	
<u>4</u>	9/19/2019	Landscaping and Irrigation Revisions		\$ 49,204.52	Pending	\$ 6,535,806.27	10/15/2019		

Greenway Improvement District
CONTRACT CHANGE ORDER

Change Order No. 4

Project: Nemours Parkway Phase 7

Date 10/14/2019

Engineer: Donald W. McIntosh Associates, Inc.

Contractor: Jr. Davis Construction Company

ITEM NO.	WORK PERFORMED	DESCRIPTION OF CHANGE	AMOUNT + / (-)
1	Landscaping & Irrigation Revisions	ADD	\$ 49,204.52

Net Change Order Amount \$ 49,204.52

Contract Amount Prior to Change Order \$ 6,486,601.75

Revised Contract Amount \$ 6,535,806.27

COMMENTS:

See attached backup provided by Jr. Davis Construction Company.

Acceptable To:

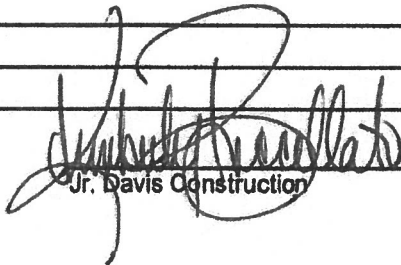
Jr. Davis Construction

Date:

10/15/19

Approved By:

Date:

Greenway Improvement District

c: Jeffrey J. Newton, P.E.

NEMOURS PARKWAY PHASE 7 LANDSCAPING & IRRIGATION REVISIONS

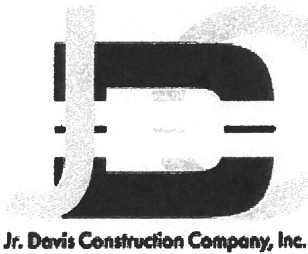

JR. DAVIS CONSTRUCTION

210 S. HOAGLAND BLVD.

KISSIMMEE, FL 34741

Contact: CONOR MACNAMARA

Phone: 407-870-0066

Email: CONOR.MACNAMARA@JR-DAVIS.COM

Quote To: Greenway Improvement District

Proposal Date: 9/9/19

Date of Plans: 6/17/19

Revision Date: 7/10/19

ITEM	DESCRIPTION	QUANTITY	UNIT	UNIT PRICE	AMOUNT
	GENERAL CONDITIONS				
110	GENERAL CONDITIONS	1.00	LS	3,831.19	3,831.19
	GENERAL CONDITIONS TOTAL				\$3,831.19
	RECLAIM WATER				
140	ADD - IRR POC CONNECTION TO 8" MAIN*	1.00	LS	17,042.93	17,042.93
	RECLAIM TOTAL				\$17,042.93
	LANDSCAPE/ IRRIGATION				
165	ADD - CATHEDRAL LIVE OAK 4"	3.00	EA	950.00	2,850.00
170	ADD - ROOT BARRIER	72.00	LF	10.35	745.20
175	ADD - SABAL PALM HURRICANE CUT	13.00	EA	335.00	4,355.00
180	ADD - MUHLY GRASS 3 GAL, 30" OC	1,273.00	EA	14.45	18,394.85
185	ADD - TEXAS LONGLEAF JASMINE	2,921.00	EA	4.90	14,312.90
190	CREDIT - ANNUALS	-127.00	EA	3.60	-457.20
195	CREDIT - FLORITAM, ST.AUGUSTINE SOD	-1,190.00	SY	5.10	-6,069.00
200	CREDIT - IRR CONTROLLER	-1.00	EA	12,354.00	-12,354.00
210	ADD - DUCTILE IRON FITTINGS	4.00	EA	221.00	884.00
215	ADD - VALVES REMOTE CONTROL TYPE 1-1/2"	4.00	EA	326.00	1,304.00
220	ADD - 1-1/2" LATERAL LINES	170.00	LF	2.75	467.50
225	ADD - 1-1/4" LATERAL LINES	985.00	LF	2.60	2,561.00
230	ADD - TREE SPRAY ASSY DOUBLE	1.00	EA	67.65	67.65
235	ADD - 12" POPUP HEADS	215.00	EA	25.55	5,493.25
240	CREDIT - 6" POPUP HEADS	-215.00	EA	19.65	-4,224.75
	LANDSCAPE/ IRRIGATION TOTAL				\$28,330.40
GRAND TOTAL					\$49,204.52

NOTES:

THIS PROPOSAL IS INCLUSIVE OF CHANGES PER THE REVISED LANDSCAPING DRAWINGS RECEIVED ON 6/17/19 AND SUBSEQUENT IRRIGATION ALTERATIONS PER MARKUP APPROVED ON 7/4/19.

*PROPOSAL ALSO INCLUDES THE RECLAIMED WATER, TAPPING SLEEVE, VALVES, IRRIGATION POC &

ABOVE GROUND BACKFLOW ASSEMBLY ADDED IN THE REVISIONS TO THE CIVIL PLANS DATED 7/10/19.

JDC Reference:1961RFC004

CC:TBD

NEMOURS PARKWAY PHASE 7

LANDSCAPE AND IRRIGATION PLANS - ISSUE FOR PERMIT
CITY OF ORLAND CASE NO. ENG2018-11778

Prepared For GREENEWAY IMPROVEMENT DISTRICT
February 13, 2018

△ Revised May 29, 2018

△ Revised September 04, 2018

△ Revised May 24, 2019

FOR REFERENCE SEE PERMIT NO. ENG2018-10209

TABLE OF CONTENTS	
SHEET NUMBER	SHEET NAME
LA5.00	COVER SHEET
LA5.01	KEY SHEET
LA5.10 - LA5.12	LANDSCAPE PLANS
LA5.90	LANDSCAPE NOTES AND PLANT LIST
LA5.91	LANDSCAPE DETAILS
LA5.99	LANDSCAPE SPECIFICATIONS
LA6.01	KEY SHEET
LA6.10 - LA6.12	IRRIGATION PLANS
LA6.90	IRRIGATION LEGEND, TABLE & NOTES
LA6.91	IRRIGATION DETAILS
LA6.99	IRRIGATION SPECIFICATIONS

Date:	06/28/18
Drawn by:	RM
Reviewed by:	JTD
Job Number:	216464
Revision:	Date:
△	05/29/2018
△	09/04/2018
△	05/24/2019

NEMOURS PARKWAY PHASE 7
ORLANDO, FL

GREENEWAY IMPROVEMENT DISTRICT
6900 TAVISTOCK BOULEVARD, ORLANDO, FL



DIXIE HITE
PARTNERS
10000 BOONVILLE AVENUE
ORLANDO, FL 32837
754.687.1771

100% LANDSCAPE PLANS

Cover Sheet

Sheet Number
LA5.00

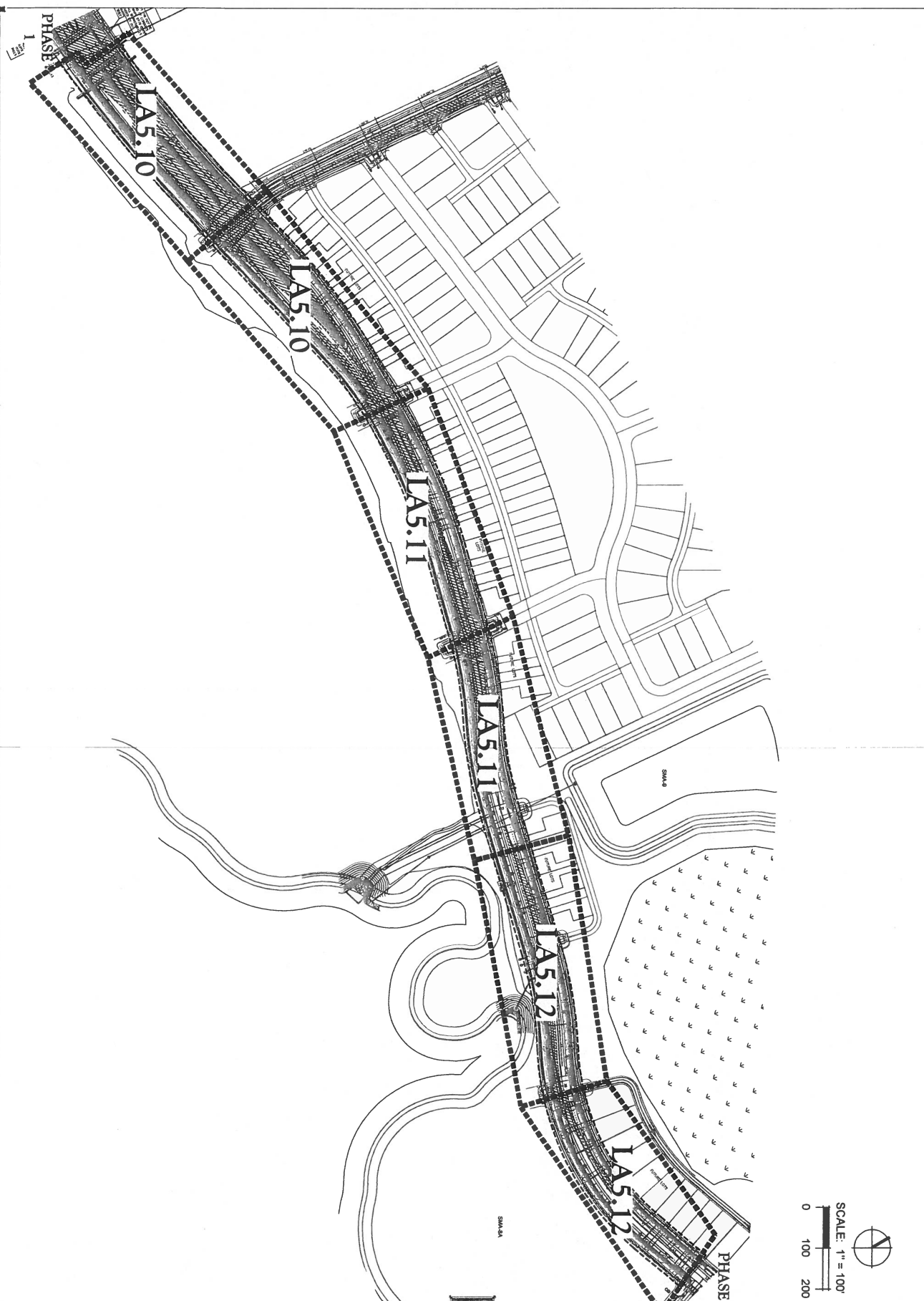

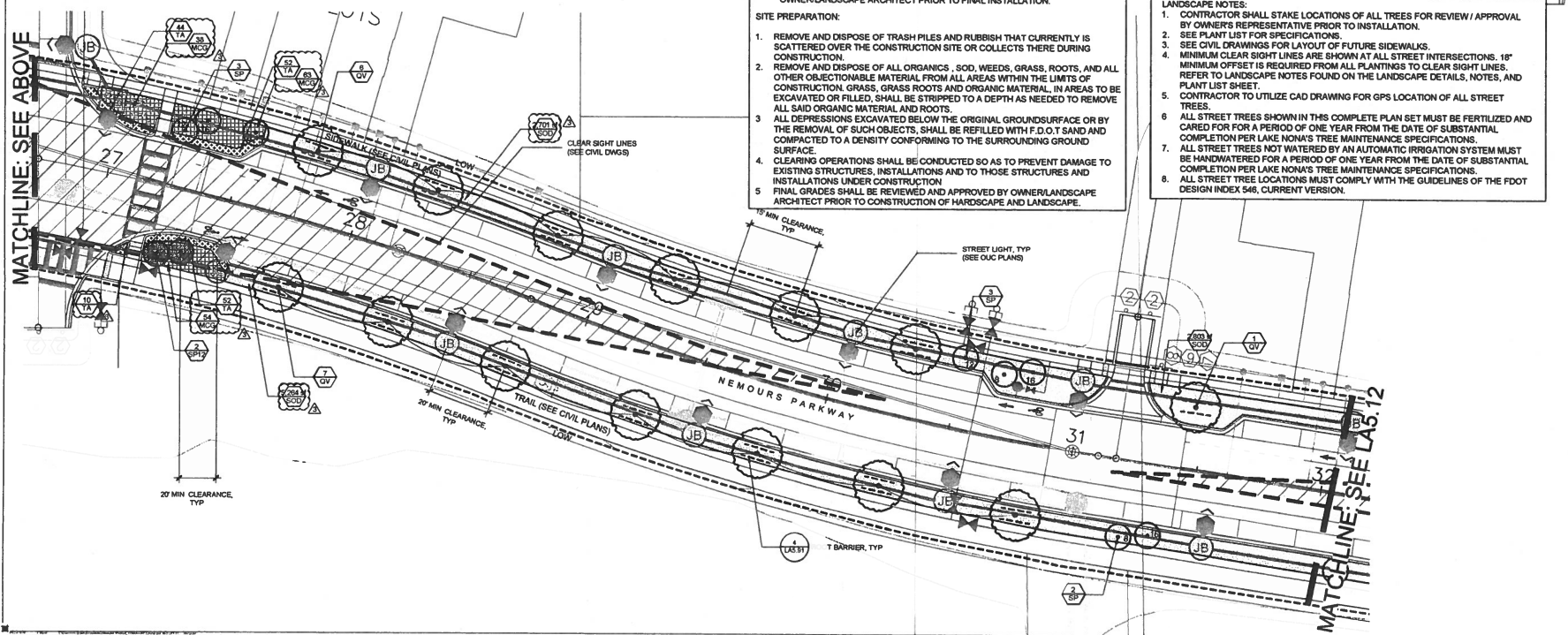
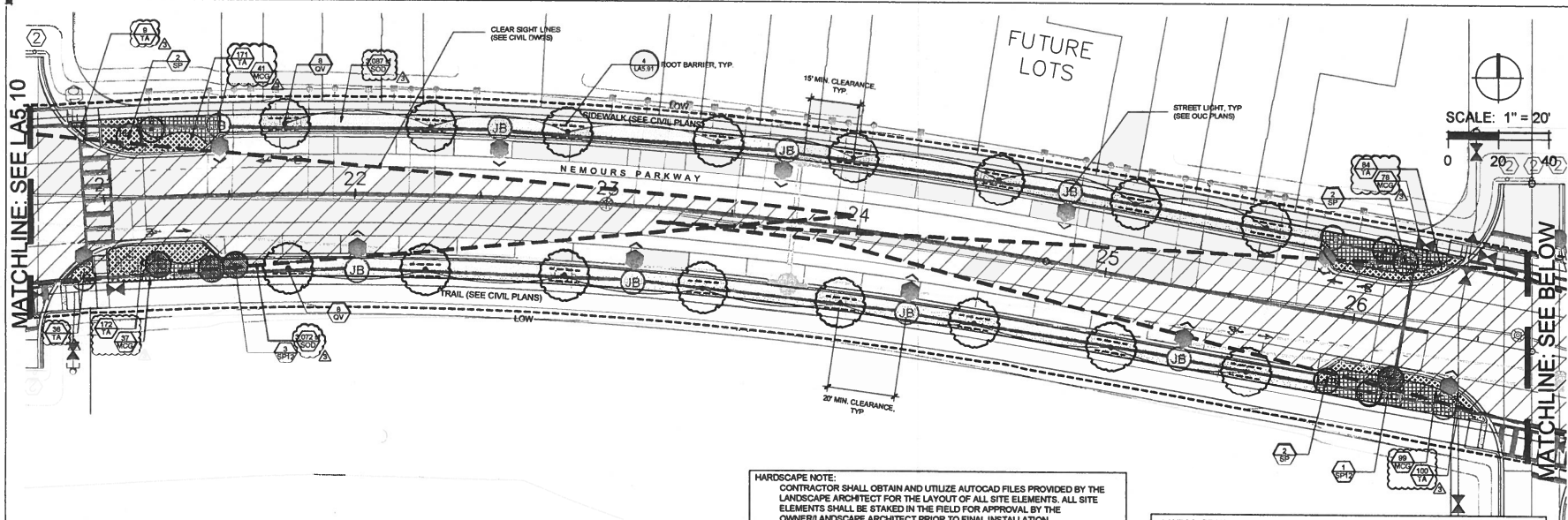

HARDSCAPE NOTE:
CONTRACTOR SHALL OBTAIN AND UTILIZE AUTOCAD FILES PROVIDED BY THE LANDSCAPE ARCHITECT FOR THE LAYOUT OF ALL SITE ELEMENTS. ALL SITE ELEMENTS SHALL BE STAKED IN THE FIELD FOR APPROVAL BY THE OWNER/LANDSCAPE ARCHITECT PRIOR TO FINAL INSTALLATION.

SITE PREPARATION:

1. REMOVE AND DISPOSE OF TRASH PILES AND RUBBISH THAT CURRENTLY IS SCATTERED OVER THE CONSTRUCTION SITE OR COLLECTS THERE DURING CONSTRUCTION.
2. REMOVE AND DISPOSE OF ALL ORGANICS, SOD, WEEDS, GRASS, ROOTS, AND ALL OTHER OBJECTIONABLE MATERIAL FROM ALL AREAS WITHIN THE LIMITS OF CONSTRUCTION. GRASS, GRASS ROOTS AND ORGANIC MATERIAL, IN AREAS TO BE EXCAVATED OR FILLED, SHALL BE STRIPPED TO A DEPTH AS NEEDED TO REMOVE ALL SAID ORGANIC MATERIAL AND ROOTS.
3. ALL DEPRESSIONS EXCAVATED BELOW THE ORIGINAL GROUND SURFACE OR BY THE REMOVAL OF SUCH OBJECTS, SHALL BE REFILLED WITH F.D.O.T SAND AND COMPACTED TO A DENSITY CONFORMING TO THE SURROUNDING GROUND SURFACE.
4. CLEARING OPERATIONS SHALL BE CONDUCTED SO AS TO PREVENT DAMAGE TO EXISTING STRUCTURES, INSTALLATIONS AND TO THOSE STRUCTURES AND INSTALLATIONS UNDER CONSTRUCTION.
5. FINAL GRADES SHALL BE REVIEWED AND APPROVED BY OWNER/LANDSCAPE ARCHITECT PRIOR TO CONSTRUCTION OF HARDSCAPE AND LANDSCAPE.

LANDSCAPE NOTES:

1. CONTRACTOR SHALL STAKE LOCATIONS OF ALL TREES FOR REVIEW / APPROVAL BY OWNER'S REPRESENTATIVE PRIOR TO INSTALLATION.
2. SEE PLANT LIST FOR SPECIFICATIONS.
3. SEE CIVIL DRAWINGS FOR LAYOUT OF FUTURE SIDEWALKS.
4. MINIMUM CLEAR RIGHT LINES ARE SHOWN AT ALL STREET INTERSECTIONS. 18" MINIMUM OFFSET IS REQUIRED FROM ALL PLANTINGS TO CLEAR RIGHT LINES. REFER TO LANDSCAPE NOTES FOUND ON THE LANDSCAPE DETAILS, NOTES, AND PLANT LIST SHEET.
5. CONTRACTOR TO UTILIZE CAD DRAWING FOR GPS LOCATION OF ALL STREET TREES.
6. ALL STREET TREES SHOWN IN THIS COMPLETE PLAN SET MUST BE FERTILIZED AND CARED FOR FOR A PERIOD OF ONE YEAR FROM THE DATE OF SUBSTANTIAL COMPLETION PER LAKE NONA'S TREE MAINTENANCE SPECIFICATIONS.
7. ALL STREET TREES NOT WATERED BY AN AUTOMATIC IRRIGATION SYSTEM MUST BE HANDWATERED FOR A PERIOD OF ONE YEAR FROM THE DATE OF SUBSTANTIAL COMPLETION PER LAKE NONA'S TREE MAINTENANCE SPECIFICATIONS.
8. ALL STREET TREE LOCATIONS MUST COMPLY WITH THE GUIDELINES OF THE FDOT DESIGN INDEX 546, CURRENT VERSION.

Date:	06/28/18
Drawn by:	RM
Reviewed by:	TD
Job Number:	11944-4
Revision:	Date:
1	05/29/2018
2	09/04/2018
3	05/24/2019

NEMOURS PARKWAY PHASE 7
ORLANDO, FL
GREENWAY IMPROVEMENT DISTRICT
6900 TAVISTOCK BOULEVARD, ORLANDO, FL



100% LANDSCAPE PLANS
Layout Plan

Sheet Number:
LA5.11

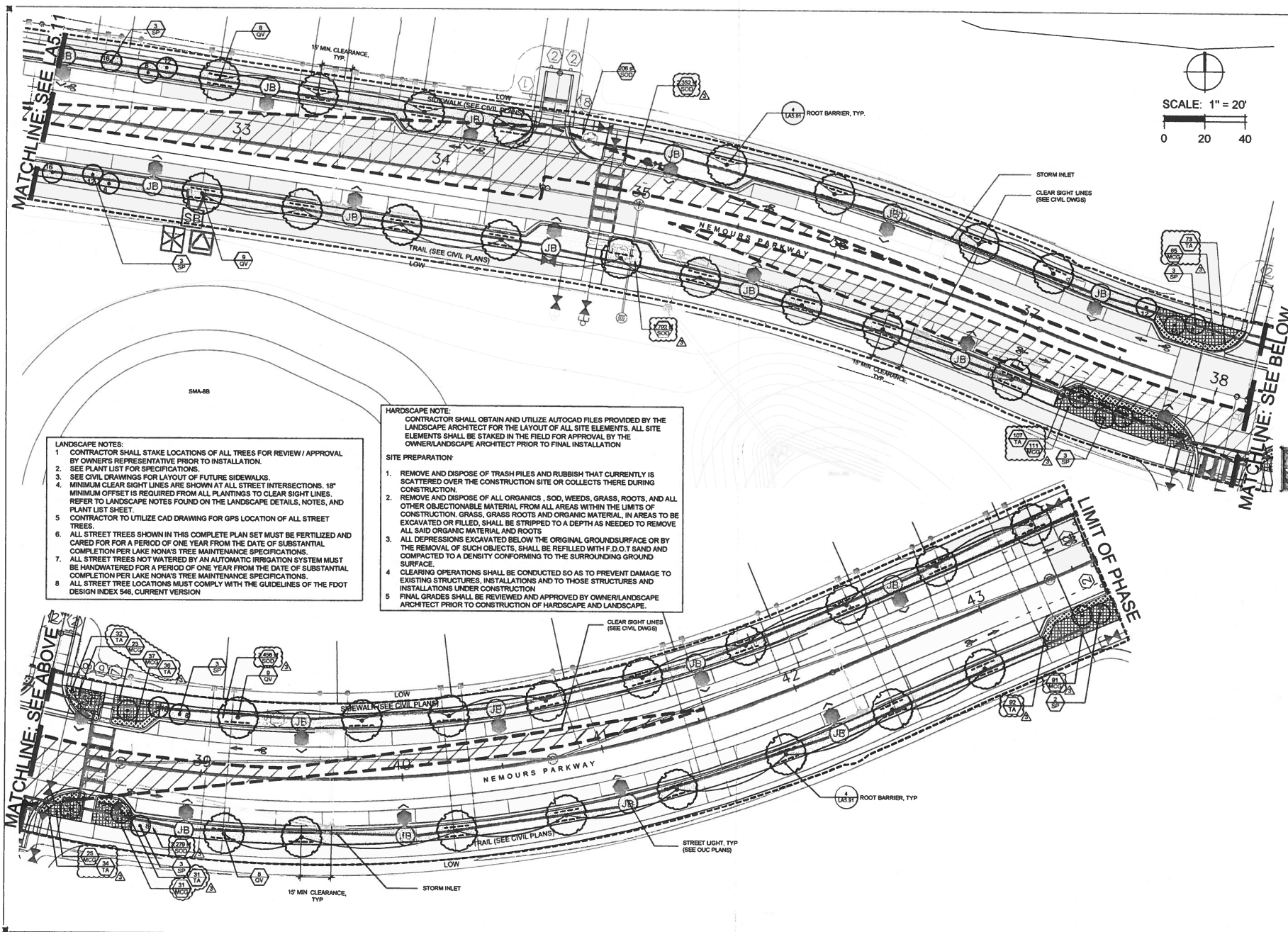

LANDSCAPE NOTES

1. CONTRACTOR IS EXPECTED TO CARRY OUT ALL RESPONSIBILITIES SET FORTH IN THESE LANDSCAPE NOTES AND IN THE LANDSCAPE SPECIFICATIONS. THEY WILL BE STRICTLY ENFORCED BY THE OWNER.
2. ALL PLANT MATERIAL SHALL BE FLORIDA #1 OR BETTER ACCORDING TO THE CURRENT NURSERY GRADES AND STANDARDS.
3. ALL PLANT BEDS SHALL BE DRESSED WITH 3" LAYER OF MULCH. ALL OTHER AREAS SHALL RECEIVE SOD (SEE PLAN FOR TYPE).
4. CONTRACTOR SHALL VERIFY ALL EXISTING UTILITIES PRIOR TO INSTALLATION.
5. ALL PLANTS SHALL MEET SIZE, CONTAINER, AND SPACING SPECIFICATIONS. ANY MATERIAL NOT MEETING SPECIFICATIONS SHALL BE REMOVED AND REPLACED AT THE CONTRACTOR'S EXPENSE.
6. CONTRACTOR SHALL BE RESPONSIBLE TO RECEIVE THE LANDSCAPE ARCHITECT'S APPROVAL OF ALL PLANT BED LAYOUTS AND TREE LOCATIONS PRIOR TO INSTALLATION. IF PLANT MATERIAL IS INSTALLED PRIOR TO LANDSCAPE ARCHITECT'S APPROVAL, CONTRACTOR WILL BE SUBJECT TO RELOCATING THE MATERIAL AT THE LANDSCAPE ARCHITECT'S REQUEST AND THE CONTRACTOR'S OWN EXPENSE.
7. ALL SHRUBS SHALL BE PLANTED 1'-1/2' AND TREES 3'-1/2' ABOVE GRADE. CONTRACTOR SHALL BE RESPONSIBLE FOR PROPER PLANT HEALTH IN ON-SITE SOILS.
8. CONTRACTOR SHALL PERFORM SOIL TESTING PRIOR TO CONSTRUCTION TO DETERMINE NUTRIENT STATUS AND PH OF SOIL AND TO DETERMINE THE SOIL TEXTURE IN THE TOP 6" - 12" OF SOIL, AND THEN AMEND THE SOIL BASED ON THE RESULTS OF THE TESTS. SEE THE LANDSCAPE SPECIFICATIONS FOR MORE INFORMATION.
9. CONTRACTOR SHALL BE RESPONSIBLE FOR FINE GRADING. GRADING SHALL BE SUBJECT TO THE APPROVAL OF THE LANDSCAPE ARCHITECT.
10. REFER TO SPECIFICATIONS FOR ADDITIONAL REQUIREMENTS.
11. CONTRACTOR SHALL SUBMIT UNIT PRICES FOR ALL BID ITEMS.
12. SOIL SHALL BE FREE FROM LIME ROCK AND CONSTRUCTION DEBRIS.
13. IN THE EVENT OF A CONFLICT BETWEEN QUANTITIES REPRESENTED ON THE PLAN VS. QUANTITIES SHOWN ON THE PLANT LIST, THE PLAN SHALL CONTROL.
14. CONTRACTOR SHALL MAINTAIN TREES IN A STRAIGHT AND PLUMB POSITION FOR ONE YEAR. CONTRACTOR SHALL STAKE ALL TREES IF REQUIRED BY THE JURISDICTION.
15. PRIOR TO REMOVAL OF ANY TREES, THE TREES TO BE RETAINED SHALL HAVE PROTECTIVE TREE BARRIERS.
16. LANDSCAPE CONTRACTOR SHALL BE RESPONSIBLE FOR THEIR OWN TAKE OFFS AND QUANTITIES. THE QUANTITIES ON THE PLANT LIST SERVE ONLY AS A GUIDE TO THE OWNER AND L.A. THIS INCLUDES SOD AND MULCH QUANTITIES OF WHICH THE CONTRACTOR SHALL BE HELD TO BID QUANTITIES.
17. SUCCESSFUL BIDDER SHALL LOCK UP ALL MATERIALS IMMEDIATELY AFTER CONTRACT ASSIGNMENT. PLANTS SHALL BE HELD DURING THE PERIOD FROM CONTRACT TO INSTALLATION TO ALLOW ADDITIONAL GROWTH. ALL PLANTS WILL BE REQUIRED TO BE FULL AND HEALTHY. CONTRACTOR SHALL ARRANGE FOR PLANT APPROVAL PRIOR TO DELIVERY, EITHER BY SAMPLES, PHOTOS, OR NURSERY VISITS.
18. CONTRACTOR SHALL BE RESPONSIBLE FOR WARRANTY OF HEALTH OF PLANTS IN ON-SITE SOILS. IF, DURING DIGGING, CONTRACTOR DISCOVERS WATER-LOGGED, CLAYED, COMPACTED OR SIMILARLY POORLY DRAINED SOILS, IT SHOULD BE BROUGHT TO THE ATTENTION OF OWNER/LANDSCAPE ARCHITECT FOR REMEDIAL ACTION.
19. CONTRACTOR SHALL ANTICIPATE THE FIRST FIVE FEET AROUND BUILDING PERIMETER WILL BE COMPACTED AND FOUNDATION BEDS SHOULD BE TILLED AND IMPROVED TO SUSTAIN VIGOROUS, HEALTHY PLANT GROWTH.

FIGURE 3 - 8
DEPARTURE SIGHT TRIANGLE
TRAFFIC APPROACHING FROM LEFT OR RIGHT

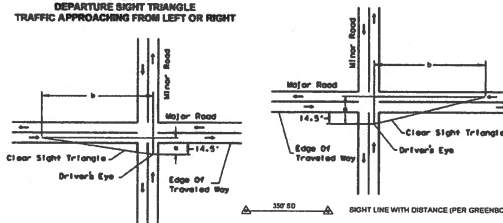

SIGHT DISTANCE LEGEND
PLAN - N.T.S.

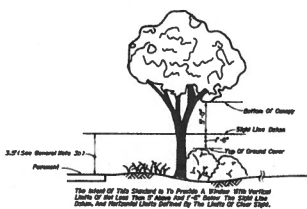

FDOT STANDARD 546 TREE SPACING DETAIL
SCALE: N.T.S.

SIGHT DISTANCE LEGEND
PLAN - N.T.S.

PLANT SCHEDULE

TREES	QTY	BOTANICAL NAME	COMMON NAME	CONT	REMARKS	
LT	10	Lagerstroemia x 'Muskogee'	Standard Lavendar Crape Myrtle	FG	B&B only, 14-16' HT., 10' SPD., 5' CT., 4" Cal., RPG, Full Healthy, Florida Fancy, Standard	
PS	3	Phoenix sylvestris	Silver Date Palm	B & B	18' C.T., Matched Hts., Full Head, Diamond Cut Trunks, Florida Fancy	
QV	99	Quercus virginiana 'Cathedral Oak'	Cathedral Oak	FG	B&B only, 14'x16', STD., 4" Cal., RPG, Full Healthy, Florida Fancy	
SP	47	Sabal Palmetto	Sabal Palm	-	Hurricane cut, See Plans for Heights, 36" Min. Dia. Root Ball, 15" Min. Dia. Trunk, Boots Shaved Just Below Crown, Clean Trunk	
SP12	12	Sabal Palmetto	Sabal Palm	-	Hurricane cut, See Plans for Heights, 36" Min. Dia. Root Ball, 11" Dia. Trunk Max., Boots Shaved Just Below Crown, Clean Trunk	
SHRUB AREAS	QTY	BOTANICAL NAME	COMMON NAME	CONT	SPACING	REMARKS
IVN	163	Ilex vomitoria 'Nana'	Dwarf Yaupon Holly	3 gal	30" o.c.	12"-14" Ht. x 12"-14" Sprd., Full, Healthy, 30" O.C.
MCG	1,273	Muhlenbergia capillaris	Muhly Grass	3 gal	30" o.c.	18" Ht. x 18" Spd., Full, Healthy
GROUND COVERS	QTY	BOTANICAL NAME	COMMON NAME	CONT	SPACING	REMARKS
LM	1,459	Liriope muscari 'Emerald Goddess'	Liriope	1 Gal.	18" o.c.	1 Gal., 6-8ppp, Full, Healthy, 18" O.C. Triangular spacing
TA	2,921	Trachelospermum asiaticum 'Texas Longleaf'	Texas Longleaf Jasmine	1 gal	18" o.c.	Full in Pot, Healthy
SOD/SEED	QTY	BOTANICAL NAME	COMMON NAME	CONT	SPACING	REMARKS
SOD	50,798 sf	Stenotaphrum secundatum 'Floritam'	Floritam St. Augustine Sod	-		Solid Sod, Healthy, Free of Weeds
MISC.		TYPE				REMARKS
MULCH		Shredded Hardwood Mulch; Natural				Shredded Hardwood Mulch from Mulch, Inc.
ROOTBARRIER		Deeproot UB 24-2				12 LF, see Landscape Plans for locations

1. AT ALL PROJECT ENTRANCES, CLEAR SIGHT DISTANCES FOR DRIVERS AND PEDESTRIANS SHALL NOT BE BLOCKED BY SIGNS, BUILDINGS, BUILDING COLUMNS, LANDSCAPING OR OTHER VISUAL IMPEDIMENTS. NO STRUCTURE, FENCE, WALL OR OTHER VISUAL IMPEDIMENT SHALL OBSTRUCT VISION BETWEEN 3 FEET AND 8 FEET IN HEIGHT ABOVE STREET LEVEL. THE APPLICANT SHALL DESIGN THE SITE PLAN AS NECESSARY TO COMPLY WITH THE FLORIDA GREENBOOK REQUIREMENTS FOR SIGHT DISTANCES AT INTERSECTIONS. LANDSCAPING LOCATED WITHIN INTERSECTION TRIANGLES AS DEFINED BY THE FLORIDA GREENBOOK SHALL BE TRIMMED OR SPACED ACCORDING TO FDOT DESIGN INDEX 546.

For safety, these additional setbacks are required:

1. Where no left turn lane is provided, at least one spacing shall conform to the Tree Spacing Table. No trees shall be planted within 100' of the restricted median area measured from the edge of pavement.
2. Where left turn lanes are provided the following requirements apply:
 - a. For top speed facilities (design speed 50 mph or greater) no trees shall be planted within 200' of the restricted median area. Beyond the 200' a 4" and spacing shall conform to the Tree Spacing Table.
 - b. For high speed facilities (design speed 50 mph or greater) no trees shall be planted within 200' of the restricted median area. Beyond the 200' a 4" and spacing shall conform to the Tree Spacing Table.

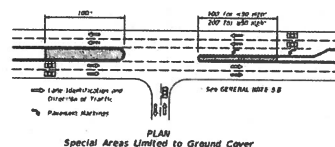

FDOT STANDARD 546 - SPECIAL AREAS LIMITED TO GROUND COVER
SCALE: N.T.S.

GENERAL NOTES:

1. SEE NOTES, SPECIFICATIONS & LEGEND SHEET FOR ADDITIONAL INFORMATION INCLUDING VERTICAL DATUM.
2. THE SCALE OF THIS DRAWING MAY HAVE CHANGED DUE TO REPRODUCTION.
3. ALL SIGHT LINES ARE DRAWN 14.5' BACK FROM THE EDGE OF TRAVEL WAY TO THE DRIVERS' EYE BASED ON FIGURE 3-8 FROM THE 2007 FLORIDA GREENBOOK AS SHOWN ON THIS SHEET.

Date: 06/28/18
Drawn by: JRM
Reviewed by: JRM
Job Number: 11446-4
Revision: Date
05/20/2018
05/24/2018
05/24/2019

NEMOURS PARKWAY PHASE 7
ORLANDO, FL
GREENWAY IMPROVEMENT DISTRICT
6900 TAYLOR BOULEVARD, ORLANDO, FL
32819-4444



100% LANDSCAPE PLANS
Landscape Details, Notes, & Plant List

Sheet Number
LA5.90

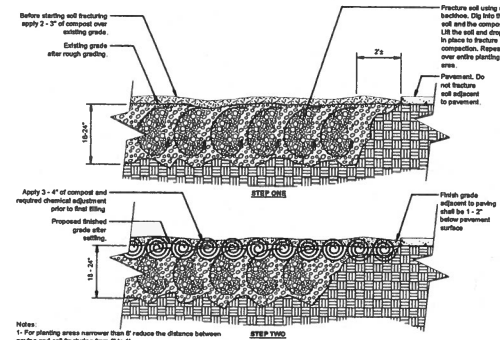
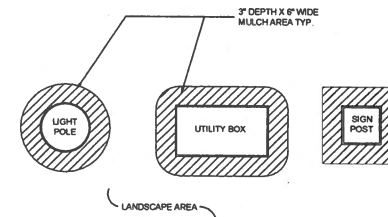
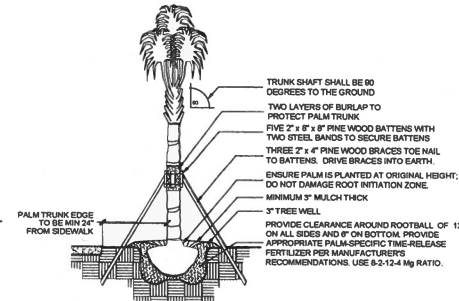
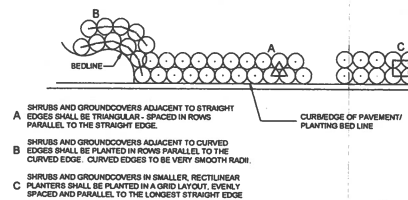
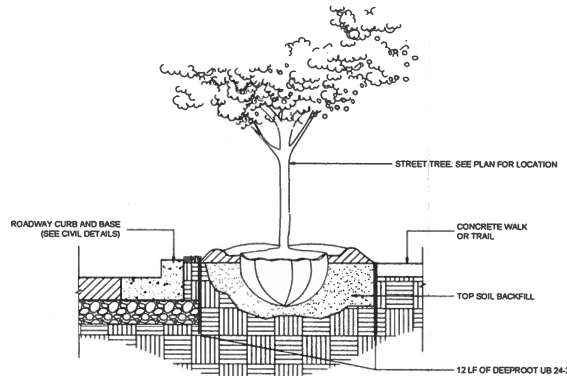
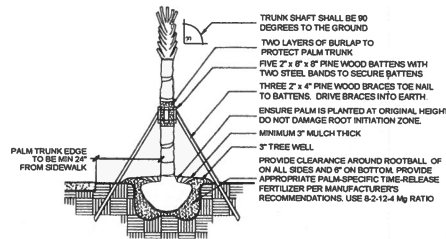
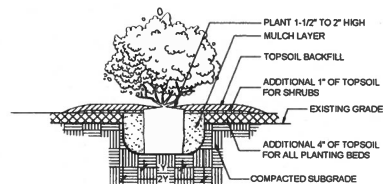
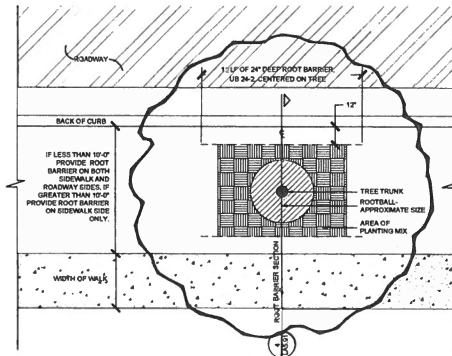
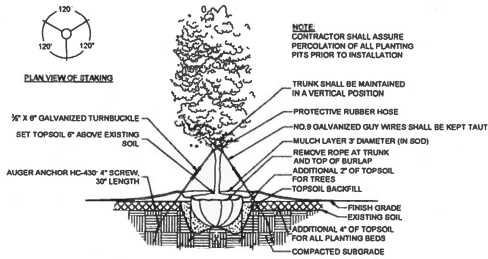

Date:	06/28/18
Drawn by:	BA
Reviewed by:	JTD
Job Number:	21046.4
Revision:	Date
	09/04/2018

NEMOURS PARKWAY PHASE 7
ORLANDO, FL
GREENWAY IMPROVEMENT DISTRICT
6900 TAVISTOCK BOULEVARD, ORLANDO, FL
904.444.1111



100% LANDSCAPE PLANS
Landscape Details, Notes, & Plant List

Sheet Number:
LA5.91

Conor MacNamara

From: Paul Stephens <paul.stephens@tavistock.com>
Sent: Thursday, July 4, 2019 10:49 AM
To: Conor MacNamara; Troy Davidson; Tarek Fahmy
Cc: Scott Thacker; Hank Blake; Josh Huynh
Subject: RE: Nemours Parkway Phase 7 - irrigation sleeves

I spoke with Lyle yesterday concerning the changes and I'm good if everyone else is. Thanks!

PAUL STEPHENS
Irrigation Specialist

Tavistock Development Company
6900 Tavistock Lakes Blvd, Suite #200
Orlando, FL 32827

C: (407) 462-7576
paul.stephens@tavistock.com

www.tavistockdevelopment.com

From: Conor MacNamara <Conor.MacNamara@jr-davis.com>
Sent: Wednesday, July 3, 2019 3:46 PM
To: Paul Stephens <paul.stephens@tavistock.com>; Troy Davidson <troy.davidson@tavistock.com>; Tarek Fahmy <tfahmy@dwma.com>
Cc: Scott Thacker <scott.thacker@tavistock.com>; Hank Blake <Hank.Blake@jr-davis.com>; Josh Huynh <Josh.Huynh@jr-davis.com>
Subject: RE: Nemours Parkway Phase 7 - irrigation sleeves

EXTERNAL E-MAIL

Apologies gents, please see revised attachment.
3DTree made some slight adjustments to the plans sent earlier today, they feel this new layout may work better.
Please review and advise if they can proceed as shown.

Thanks,

Conor MacNamara
Project Engineer

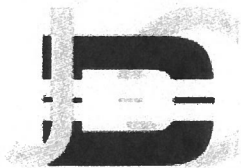

Jr. Davis Construction Company, Inc.
160 International Parkway

Date	08/13/2018
Drawn by	CS
Check by	CS
Scale	1"=20'
Revision	1
Author	CS
Checker	CS
Project	LA6.10
Sheet	LA6.10

NEMOURS PARKWAY PHASE 7
GREENWAY IMPROVEMENT DISTRICT
 ORLANDO, FL
 4900 TAVISTOCK BOULEVARD, ORLANDO, FL



100% IRRIGATION PLANS
 Irrigation Plan

LA6.10
 Sheet Number

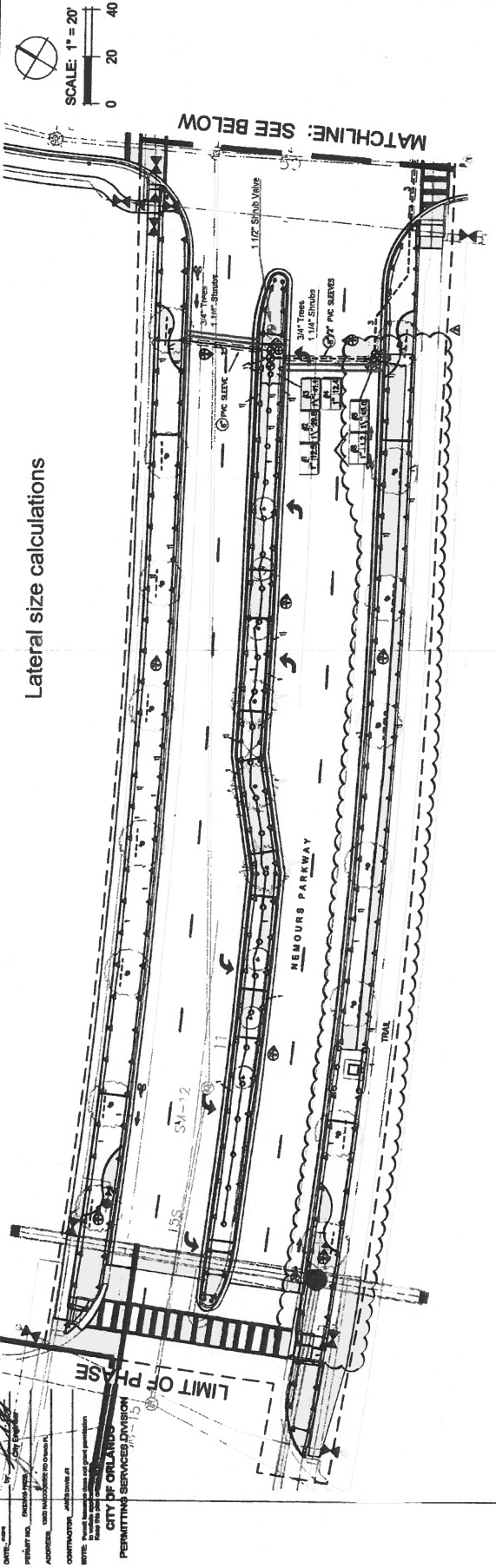

Lateral size calculations

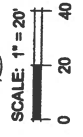

MATCHLINE: SEE BELOW

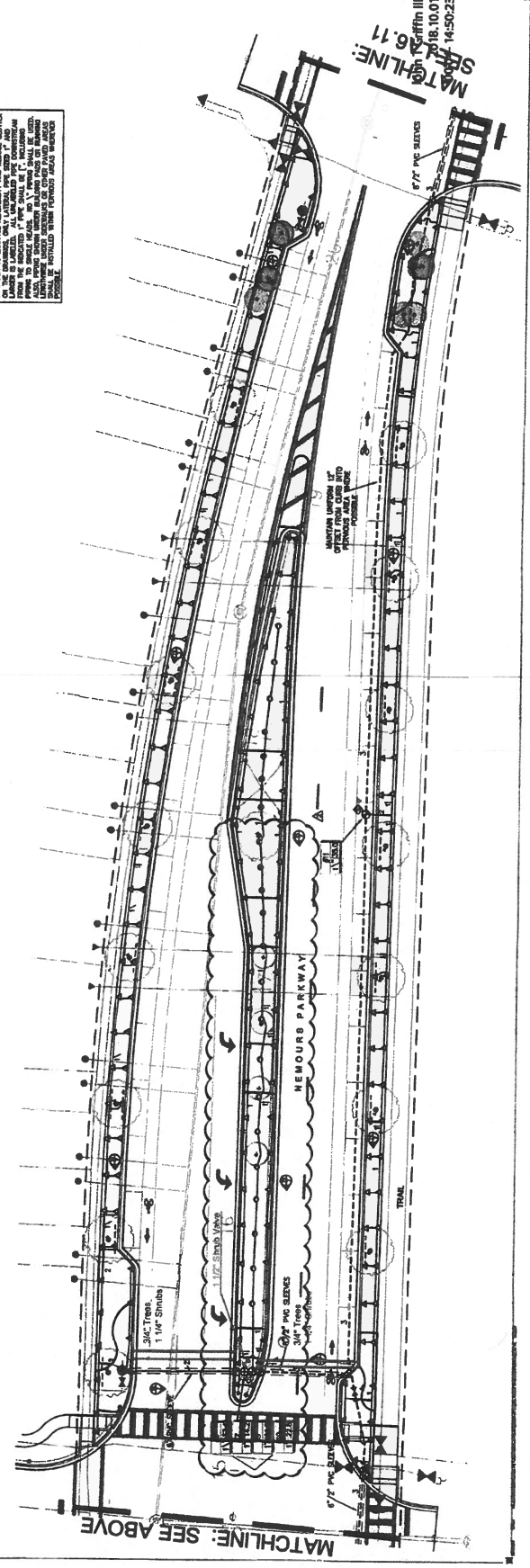

MATCHLINE: SEE ABOVE

MATCHLINE: SEE 26.11
 14:50:23

IN ORDER TO ENSURE RELIABILITY AND REDUCE CLUTTER, ALL IRRIGATION LATERALS SHALL BE LOCATED AT LEAST 12\"/>

REVIEWED FOR CODE COMPLIANCE
 DATE: 08/13/2018
 PROJECT NO.: 18-1001
 APPROPRIATION: 18-1001
 CONTRACTOR: AMERISOURCE
 CITY OF ORLANDO
 PERMITTING SERVICES DIVISION

REVIEWED FOR CODE COMPLIANCE

DATE: 08/01/17 BY: [Signature]

PROJECT NO. 2016-1173

CONTRACTOR: [Signature]

ADDRESS: 1800 TAVISTOCK BOULEVARD, ORLANDO, FL

CITY OF ORLANDO

PERMITTING SERVICES DIVISION

Lateral size calculations

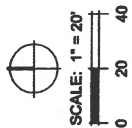
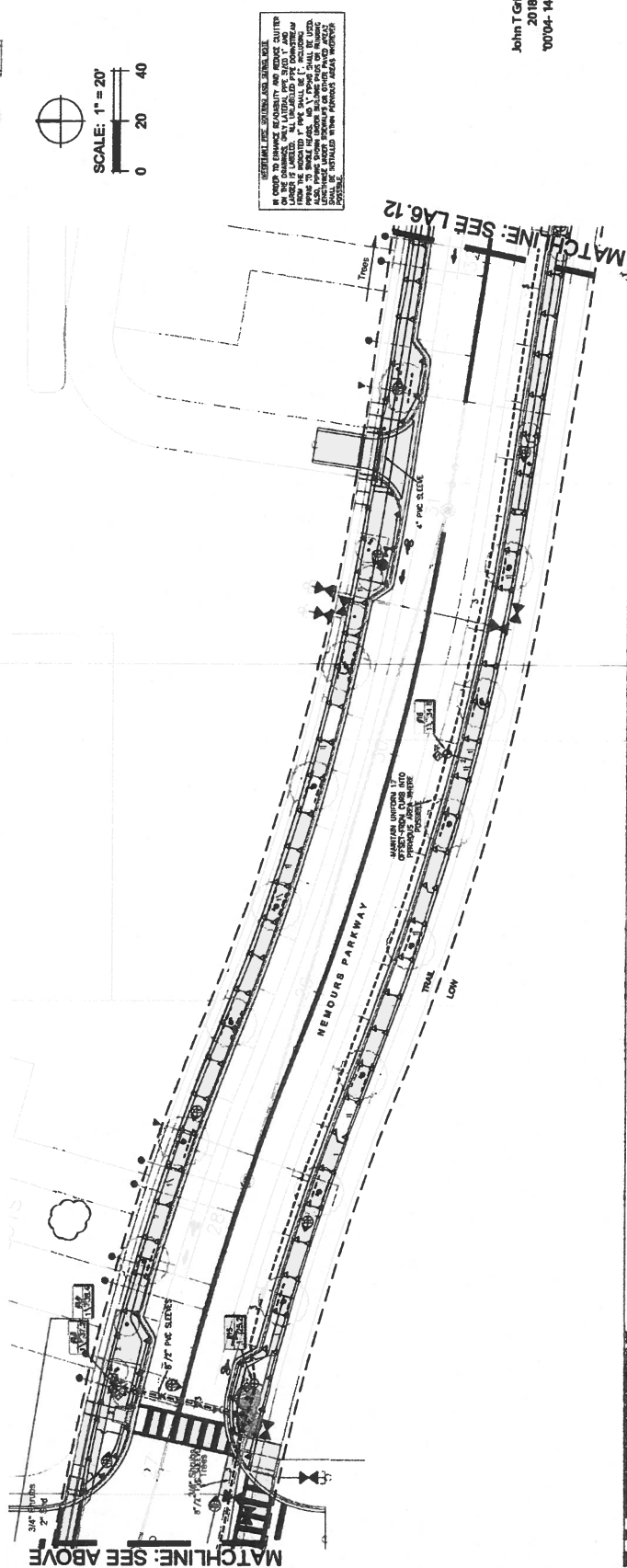
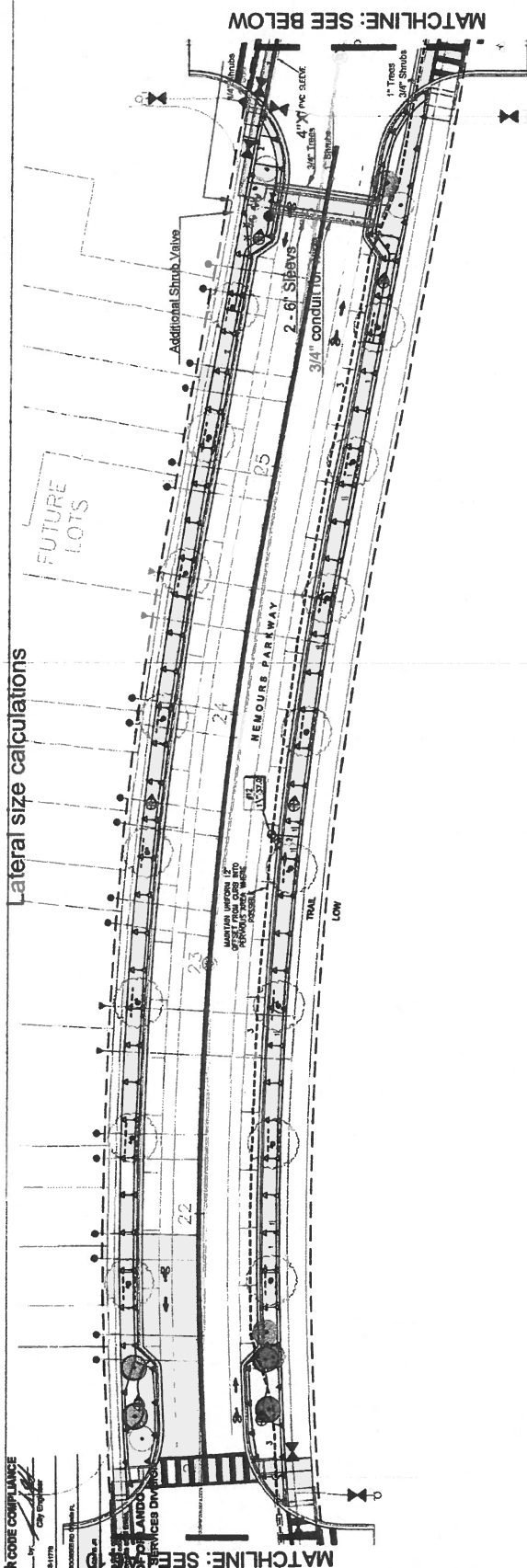

INSTALL THE MAINLINE AND SIZES ARE
IN ORDER TO MINIMIZE EXHAUSTION AND REDUCE DILUTION
ON THE DAMAGED. ONLY LATERAL PIPE SHALL BE 1\"/>

PERMITTING SERVICES DIVISION

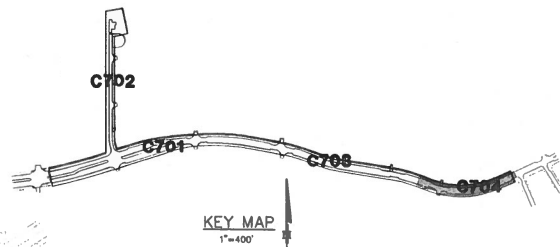

- white
kirby |
white
DN c=US,o=DONALD W.
MCINTOSH ASSOCIATES
INC.,ou=DONALD W.
MCINTOSH ASSOCIATES
INC.,cn=kirby | white,
0.9.2342.19200300.100.1.
1=A01097C00000153C2
DEB9C100012575
Date: 2019.07.22 15:31:06
-04'00'

DRAWING 16100-467-42-REV C	LAKE NONA NEMOURS PARKWAY PHASE 7 CITY OF ORLANDO, FLORIDA RECLAIMED WATER PLAN	 DONALD W. MCINTOSH ASSOCIATES, INC. ENGINEERS PLANNERS 5018/11028 2500 PARK AVENUE NORTH, WINTER PARK, FL 32789/027 864-0088 CERTIFICATE OF AUTHORIZATION No. 44	SHEET C704 88 OF 104	1 2 3 4 5 6 7 8 9 10 11 12 13 14 15 16 17 18 19 20 21 22 23 24 25 26 27 28 29 30 31 32 33 34 35 36 37 38 39 40 41 42 43 44 45 46 47 48 49 50 51 52 53 54 55 56 57 58 59 60 61 62 63 64 65 66 67 68 69 70 71 72 73 74 75 76 77 78 79 80 81 82 83 84 85 86 87 88 89 90 91 92 93 94 95 96 97 98 99 100 101 102 103 104 105 106 107 108 109 110 111 112 113 114 115 116 117 118 119 120 121 122 123 124 125 126 127 128 129 130 131 132 133 134 135 136 137 138 139 140 141 142 143 144 145 146 147 148 149 150 151 152 153 154 155 156 157 158 159 160 161 162 163 164 165 166 167 168 169 170 171 172 173 174 175 176 177 178 179 180 181 182 183 184 185 186 187 188 189 190 191 192 193 194 195 196 197 198 199 200 201 202 203 204 205 206 207 208 209 210 211 212 213 214 215 216 217 218 219 220 221 222 223 224 225 226 227 228 229 230 231 232 233 234 235 236 237 238 239 240 241 242 243 244 245 246 247 248 249 250 251 252 253 254 255 256 257 258 259 260 261 262 263 264 265 266 267 268 269 270 271 272 273 274 275 276 277 278 279 280 281 282 283 284 285 286 287 288 289 290 291 292 293 294 295 296 297 298 299 300 301 302 303 304 305 306 307 308 309 310 311 312 313 314 315 316 317 318 319 320 321 322 323 324 325 326 327 328 329 330 331 332 333 334 335 336 337 338 339 340 341 342 343 344 345 346 347 348 349 350 351 352 353 354 355 356 357 358 359 360 361 362 363 364 365 366 367 368 369 370 371 372 373 374 375 376 377 378 379 380 381 382 383 384 385 386 387 388 389 390 391 392 393 394 395 396 397 398 399 400 401 402 403 404 405 406 407 408 409 410 411 412 413 414 415 416 417 418 419 420 421 422 423 424 425 426 427 428 429 430 431 432 433 434 435 436 437 438 439 440 441 442 443 444 445 446 447 448 449 450 451 452 453 454 455 456 457 458 459 460 461 462 463 464 465 466 467 468 469 470 471 472 473 474 475 476 477 478 479 480 481 482 483 484 485 486 487 488 489 490 491 492 493 494
-------------------------------	--	--	-----------------------------------	--

**LAKE NONA SOUTH
Greenway Improvement District
Kellogg Avenue Extension
Change Order Log
Dewitt Excavating**

C.O. #	Date	Description of Revision	Additional Days	Amount	Status	New Contract Amount Original Contract Date	To Board	Approval Date	Notes
						\$1,797,324.58			
1	7/12/2018	Developer Portion - Stabilize Construction Access Road and Import Fill	0	\$230,500.00	Approved	\$2,027,824.58	7/17/2018	7/17/2018	
2	8/1/2018	Add days to contract due to weather	8	\$0.00	Approved	\$2,027,824.58	8/23/2018	8/23/2018	
3	9/14/2018	OUC Access Revision - electric and street lighting layout configuration - Kellogg Avenue Extension	0	-\$2,146.88	Approved	\$2,025,677.70	9/18/2018	9/18/2018	
4	9/14/2018	OUC Access Revision - electric and street lighting layout configuration - Hartwell Court Extension	0	\$65,127.18	Approved	\$2,090,804.88	9/18/2018	9/18/2018	
5	10/15/2018	Change of Oak Trees to Acer Rubrum	0	-\$500.00	Approved	\$2,090,304.88	10/16/2018	10/16/2018	
6	10/16/2018	Addition of compost to plant area for Canopy Trees only	0	\$1,691.88	Approved	\$2,091,996.76	11/19/2018	11/19/2018	
7	2/4/2019	Credit for dirt not imported	0	-\$124,608.00	Approved	\$1,967,388.76	2/19/2019	2/19/2019	
8	1/7/2019	Core and connection for SM07 - Soccer Field; Water Service Connection for Soccer Field and Water park	0	\$19,077.25	Approved	\$1,986,466.01	2/19/2019	2/19/2019	
9	2/6/2019	Stop sign and thermopaint	0	\$1,956.00	Approved	\$1,988,422.01	2/19/2019	2/19/2019	
10	2/19/2019	Change of street sign	0	\$750.00	Approved	\$1,989,172.01	3/19/2019	3/19/2019	
11	rev 8/26/2019	Drainage improvements along future northerly extension of Centerline Drive	0	\$202,994.27	Approved	\$2,192,166.28	8/20/2019	8/20/2019	
12	9/17/2019	(formerly Kellogg CO #10 by Tavistock) Irrigation Repairs	0	\$2,220.00	Approved	\$2,194,386.28	9/17/2019	9/17/2019	

GREENEWAY IMPROVEMENT DISTRICT

**Resolution 2020-01,
Adopting a Revised Budget for FY 2019
*(provided under separate cover)***

GREENEWAY IMPROVEMENT DISTRICT

**Requisition Nos. 665 – 668 & 2018-31 – 2018-36
Approved in October 2019 in an amount totaling
\$981,967.04
*(provided under separate cover)***

GREENEWAY IMPROVEMENT DISTRICT

**Operation and Maintenance Expenditures Paid
in October 2019 in an amount totaling \$84,511.65
*(provided under separate cover)***

GREENEWAY IMPROVEMENT DISTRICT

**Recommendation of Work
Authorizations/Proposed Services
*(if applicable)***

GREENEWAY IMPROVEMENT DISTRICT

Recommendation for Work Authorization / Proposed Services

Project Name: GID – Centerline Drive Segment C

Brief Description: Underground locates for Centerline Drive Road Construction Plans.

Name of Consultant / Vendor: Central Florida Locating, Inc.

Is this work pursuant to an existing Agreement? Yes ✓ No

If so, name and date of Agreement: _____

Is this project included in the District Capital Improvement Plan? ✓ Yes No

Are the services required contemplated in the Capital Improvement Plan? ✓ Yes No

Is this a continuation of previously authorized work? ✓ Yes No

Proposal attached: ✓ Yes No

Form of Agreement Utilized: Proposal

Amount of Services: \$ 1,160.00

Recommendation: ✓ Approve Deny

By:

Larry Kaufmann 11/10/15

Larry Kaufmann, Chairman
Greeneway Improvement District Construction Committee

c: Jennifer Walden
Tucker Mackie
Jeffrey Newton
Lynne Mullins



Central Florida Locating, Inc.
dba CFL Geological Solutions

PO Box 1468
Bushnell, FL 33513
833-229-2227
cfl-inc.com

Date: 11-7-19
Client: Greenway Improvement District, 12051 Corporate Blvd, Orlando, FL 32817
Attn: Mr. Richard Levey, Chairman, Board of Supervisors
E-Mail: Scott Grossman, PSM, Senior Vice President, Donald W. McIntosh Associates, Inc. <sgrossman@dwma.com>
Project: Lake Nona South – VAMC Access Road, Hartwell Ct, Orlando, FL – **Additional Area** **CFL 19303**

CFL is pleased to provide a proposal to Greenway Improvement District for the additional area based upon scope of services requested by Scott Grossman of D.W. McIntosh Associates (DWMA), may be subject to change should the requirements change, is valid for thirty (30) days from date of proposal, and is Non-Transferrable.

SCOPE OF SERVICES - See Page 2 for Information/Limitations

Geophysical Horizontal Utility Locating: 2D Ground Penetrating Radar (GPR) and Electromagnetic (EM)

- CFL will utilize 2D GPR and EM technologies to horizontally locate underground utilities within the red outlined area as shown on the attached print provided by Scott Grossman of DWMA. The exact locate area will need to be designated at time of work by DWMA.
- CFL will use paint and flags to mark located utilities and will provide a technician's field drawing of located utilities.
- CFL's scope of services does not include the locating of abandoned utilities that are no longer locatable, vacant conduits, gravity sewer, storm lines, small irrigation lines, and low voltage lines.
- *Client is responsible for ensuring that all electrical and lighting systems are energized and that all lights with outdoor light sensor systems are in use at time of locate work.*

Notes:

- *If available, CFL requests that client provide as-builts, engineering prints, etc. of existing utilities.*
- *GPR Scans & EM Locating can only be performed in accessible areas that are clear of obstacles such as construction materials, pipes, vehicles, machinery, dirt/materials mounds, landscaping, trees, uneven terrain, water, etc.*
- *If needed, CFL can provide a quote for additional detection technologies such as 3D GPR, 3D GPR Array, and Magnetometer that typically provide additional/more comprehensive data.*

WEEKDAY DAYTIME COST

Geophysical Horizontal Locating: -----\$1,160.00

PAYMENT

- A Lump Sum invoice will be submitted via e-mail to client upon completion of locate work.
- Lump Sum amount is due in full with no job retainage.
- Payments not received within 30 days of date of invoice may result in legal actions.

SCHEDULE

A work start date will be provided upon receiving an Authorization to Proceed.

Regards,

Sandra Rickerson

Sandra Rickerson, President
Central Florida Locating, Inc.

AUTHORIZATION TO PROCEED (ATP) – Executed CFL Proposal

ATP - Client legally authorizes CFL to proceed and acknowledges that scope of services, compensation, payment terms, and terms and conditions in this proposal are accepted.

Client: Greenway Improvement District

Date: _____

By: _____
Authorized Agent's Signature

Printed Name: _____
Printed Name of Authorized Agent

Job Number/Name (If Applicable): _____

E-MAIL Address for Invoice: _____

E-MAIL EXECUTED DOCUMENT TO: Contracts@cfl-inc.com

Innovative and Reliable Solutions



Terms and Conditions

Central Florida Locating, Inc.
DBA CFL Geological Solutions

Page 2

(A) LIMITS OF GPR AND ELECTROMAGNETIC SERVICES: If Services are Provided

CFL will make every effort to horizontally detect the underground utilities, objects or voids described in the Scope of Work or as requested at the time of work within the designated work area(s). However, CFL cannot mark utilities/objects/voids that are undetectable. Therefore, CFL **cannot guarantee** that all subsurface utilities/objects/voids will be accounted for. Locate limitations that CFL will not be held liable for include but are not limited to:

- **GROUND PENETRATING RADAR (GPR):**
 - GPR investigations are highly site specific and can be limited by attenuation of GPR signals by subsurface materials.
 - GPR investigations are limited by uneven terrain conditions, bushes, trees, debris, etc.
 - All vertically stacked utilities/objects may not be detected since GPR signals are reflected by the top most utility/object.
 - Some utilities/objects may not return a reflected signal to the GPR receiver.
 - GPR scans cannot be made immediately next to buildings/objects due to equipment restrictions.
 - Pipes with little or no liquid content at time of locate work may not be detected with GPR.
- **ELECTROMAGNETIC LOCATING :**
 - The number of access points within designated locate area(s) may be limited or non-existent.
 - Utility or property owner may restrict or deny the use of utility access points.
 - Utility may not adequately carry the imposed current from the electromagnetic locate equipment.
 - Fiber & other non-metallic lines with no or non-working tracer wire are untoneable with electromagnetic locate equipment.

(B) DESIGN ENGINEER and CONTRACTORS

Due to locate limitations, the client's/owner's Design Engineer is expected to gather and identify existing facility information from various prints and underground facility owners/operators to confirm that no other subsurface utilities/objects are present in the project area, and Contractors are responsible to abide by Florida Statutes 556.106 - Sunshine 811.

(C) FIELD DRAWINGS/PRINTS/REPORTS

CFL is not liable for any print, survey, field drawing or report that identifies or fails to identify CFL detected utilities or objects. CFL field drawings represent the requested scope of services within designated area(s) as of date of work; may not reflect a comprehensive utility survey of all subsurface utilities/objects; are not technical drawings created by a professional such as surveyor, engineer, or draftsman; are not drawn to scale and only depict an approximate location of referenced utilities/objects; are not created based on any type of drawing standards; and are for informational purposes only.

(D) MACHINE DEPTHS: If Service is Provided

Machine depths are approximate readings, **are not guaranteed depths**, are provided for informational purposes only, and should not be relied upon for any type of subsurface work. CFL will not accept any responsibility for actions taken based on provided machine depths.

(E) VERTICAL EXCAVATION (DIRT SOFT DIG): Information/Limitations: If Service is Provided

Soft Digs are made within grassed or otherwise unpaved surface conditions to a maximum depth of approximately 8 feet to determine the depth of the utility/object. If requested, CFL also will provide the size and material type.

- Soft Dig vertical depth measurements are made from the top of each exposed utility/object to the ground surface.
- The vertical depth range and visual inspection ability is dependent on events such as ground water level.

(F) CORE BORE WITH VERTICAL EXCAVATION (DIRT SOFT DIG): Information/Limitations: If Service is Provided

A Core Bore is made in asphalt or concrete to vertically expose a utility/object to determine the depth of the utility/object from the top of the utility/object to the pavement surface.

- Vertical Excavation limits apply (See Item E).
- Test hole will be backfilled with like materials compacted in 6" lifts or with a flowable fill mixture.
- The current asphalt thickness will be replaced with double asphalt thickness.

(G) DIRECT PUSH SOIL SAMPLING: Information/Limitations: If Service is Provided

Direct Push Soil Sampling limitations that CFL will not be held liable for include but are not limited to:

- Direct push rods may not penetrate to desired depth due to subsurface sediment and/or material hardness.
- Direct push rods may not penetrate through consolidated sediment, rock and/or debris.

(H) CERTIFICATE OF INS (COI): New/Revised COI Requests

- Client COI requirements must be provided to CFL prior to the Authorization to Proceed being issued.
- CFL will invoice client for all costs associated with client COI requirements that incur billable charges to CFL.

CFL Utility Locate Site:
VAMC Access Road
Hartwell Ct, Orlando, FL

CFL will locate the underground utilities within the red outlined area going from the Edge of Pavement to the R/W Line.

VETERAN'S ADMINISTRATION
MEDICAL COMPLEX
(UNDER CONSTRUCTION)

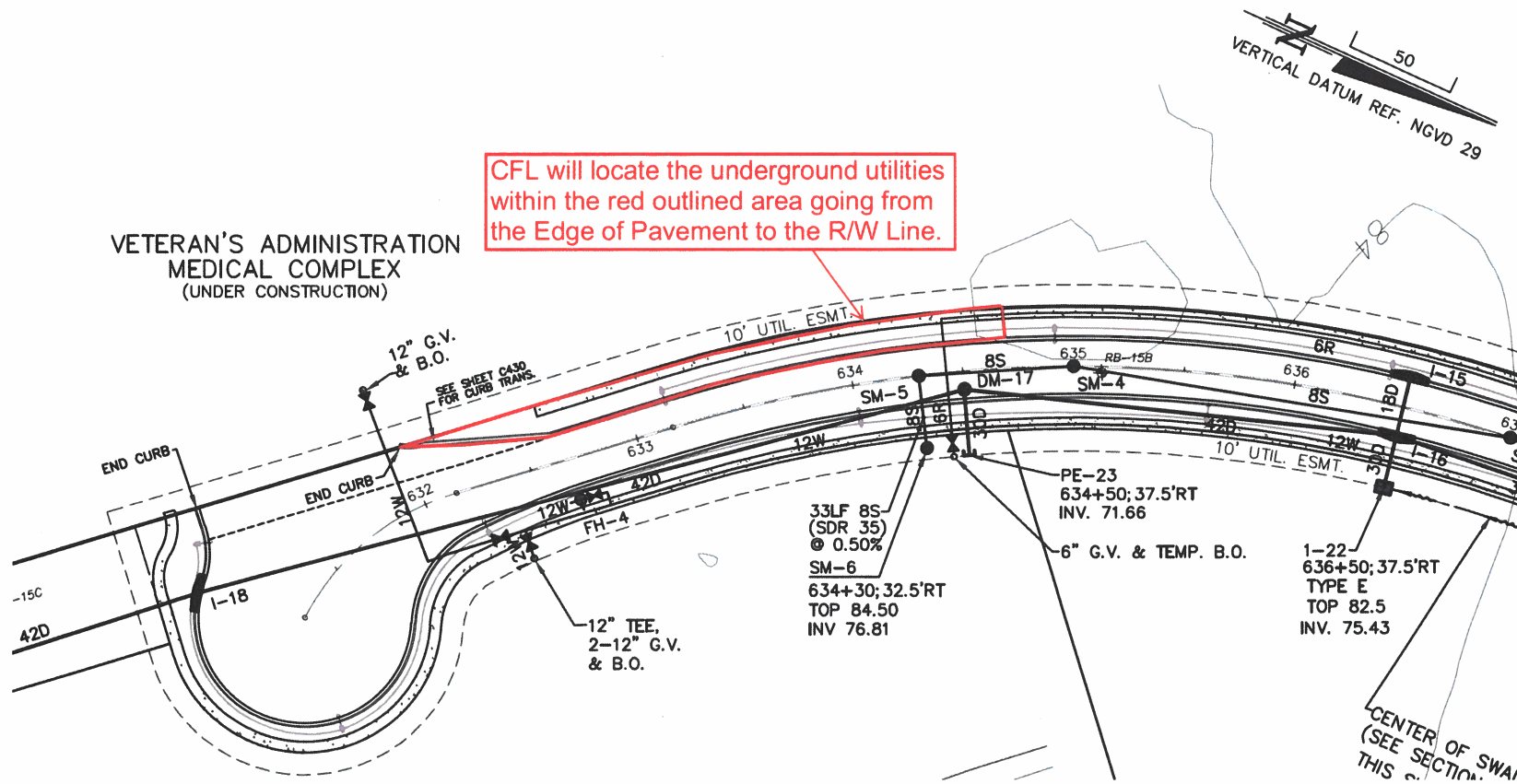

Central Florida Locating, Inc.
-CFL Geological Solutions

114 N Jumper Drive
Bushnell, FL 33513
Office: (352) 793-4246
Fax: (352) 793-8675

"Innovative and Reliable
Subsurface Solutions"

Client:	Greenway Improvement District	Date:	11/7/19	<small> Assured Notes Central Florida Locating, Inc. (CFL) is an Associate Member of the Florida Services Under the GSA System. General Excise Taxing, Inc. (GETI) is a Florida Service Under the GSA System. Disclaimer: Central Florida Locating, Inc. (CFL) will not be held responsible for any information provided in this drawing, any action taken as a result of using this drawing, or any utilities listed and not listed in this drawing. Furthermore, CFL cannot guarantee that all utilities and wells have been accounted for and cannot be held liable for undetected utilities. If digging in any of the areas described in this drawing, please call CFL at (352) 793-4246 to have the utilities located. This drawing may not be reproduced without the written consent of CFL. </small>
Project:	Lake Nona South - VAMC Access Road		Proposal	
Methods:	2D Ground Penetrating Radar (2D GPR) and Electromagnetic (EM)	Sheet:	1 of 1	

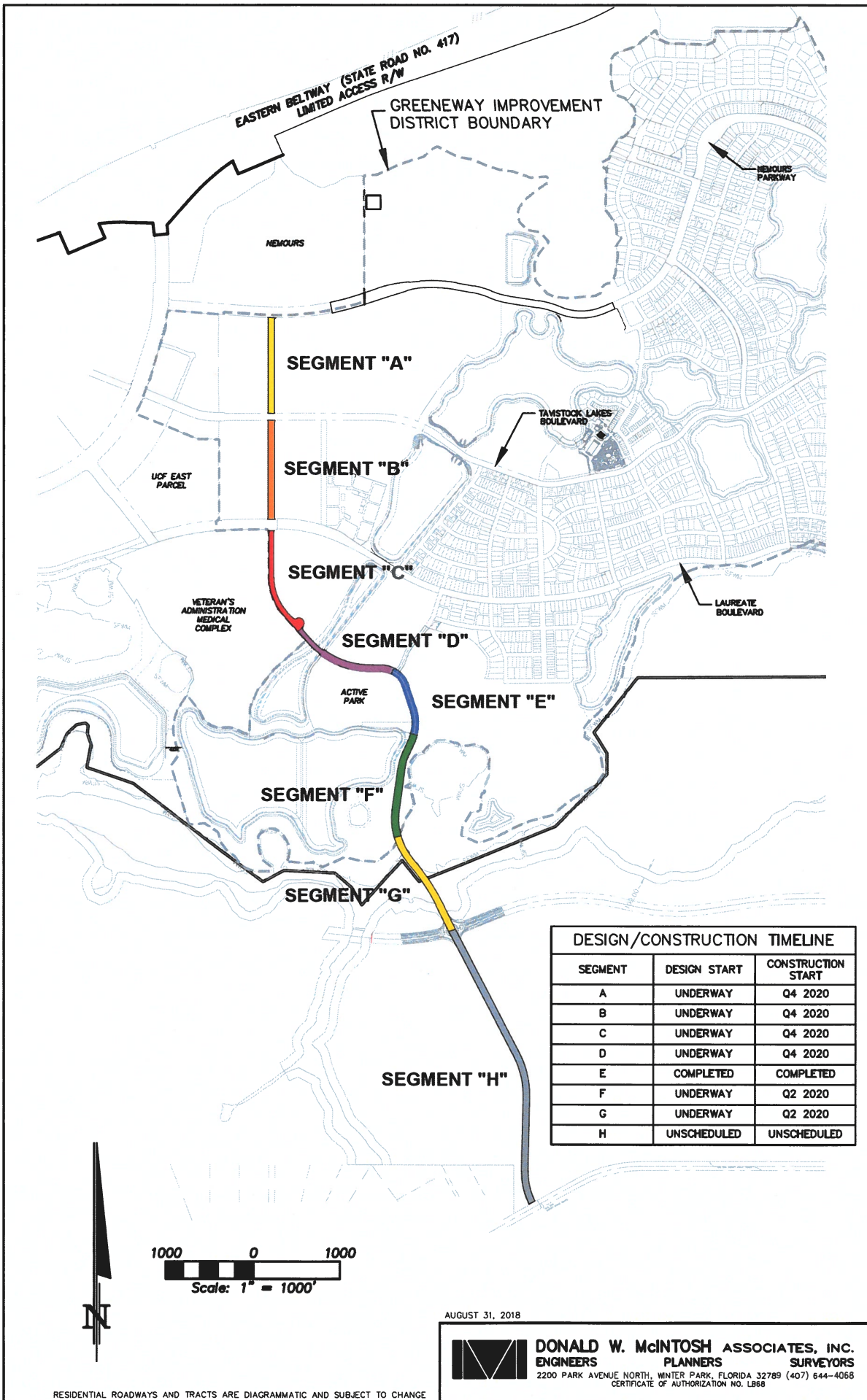

RESIDENTIAL ROADWAYS AND TRACTS ARE DIAGRAMMATIC AND SUBJECT TO CHANGE

GREENEWAY IMPROVEMENT DISTRICT

**District's Financial Position and
Budget to Actual YTD
*(provided under separate cover)***